

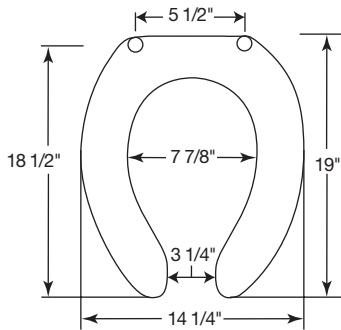

HOSPITALITY PLASTIC SEATS

MODEL 1955CTJ

- ELONGATED SEAT, OPEN FRONT LESS COVER
- HEAVY DUTY SOLID PLASTIC
- JUST•LIFT®, INTEGRATED HINGE SYSTEM
- STA-TITE®, COMMERCIAL FASTENING SYSTEM™



Ring thickness is 1"
 Ring thickness including the bumper is 1-3/16"
 Height of the seat is 2-1/4"

Seats shall be 1955CTJ as manufactured by Church Seats. Seats shall be heavy weight and injection-molded of solid plastic. Seats shall be open front less cover for elongated bowl and feature large molded-in bumpers. Seats shall have STA-TITE®, Commercial Fastening System™, featuring external check hinges with 300 Series stainless steel posts and pintles that stop 11 degrees beyond vertical. Seats shall feature JUST•LIFT® integrated hinge system for enhanced cleanability and hygiene. Color to be White.

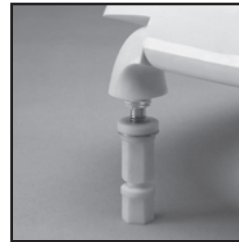

STA-TITE®, COMMERCIAL FASTENING SYSTEM™, ONE-PIECE INTEGRATED NUT AND WASHER



JUST•LIFT® PROVIDES 1-1/2" OF LIFT HEIGHT FOR ENHANCED CLEANABILITY

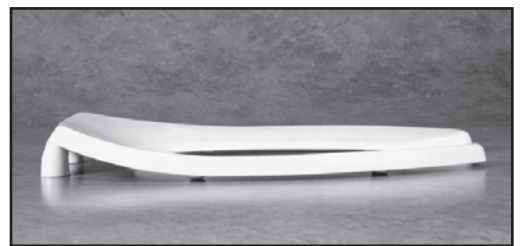

CONTOURED SEAT

JUST•LIFT®

with STA-TITE®
 Commercial Fastening System™

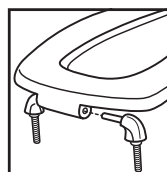

Assemble hinges.

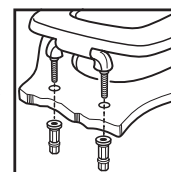

Finger-tighten fastening nuts.

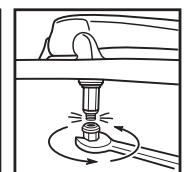

Using wrench, tighten until lower portion shears off.