

Vero™ Tub/Shower Trim Garniture pour Bain/Douche Vero™

Adorno Vero™ para Bañera/Ducha

Vero™ Tub/Shower

Models/Modelos/Modèles T14253-H2O & T14453-H2O Series/Series/Seria

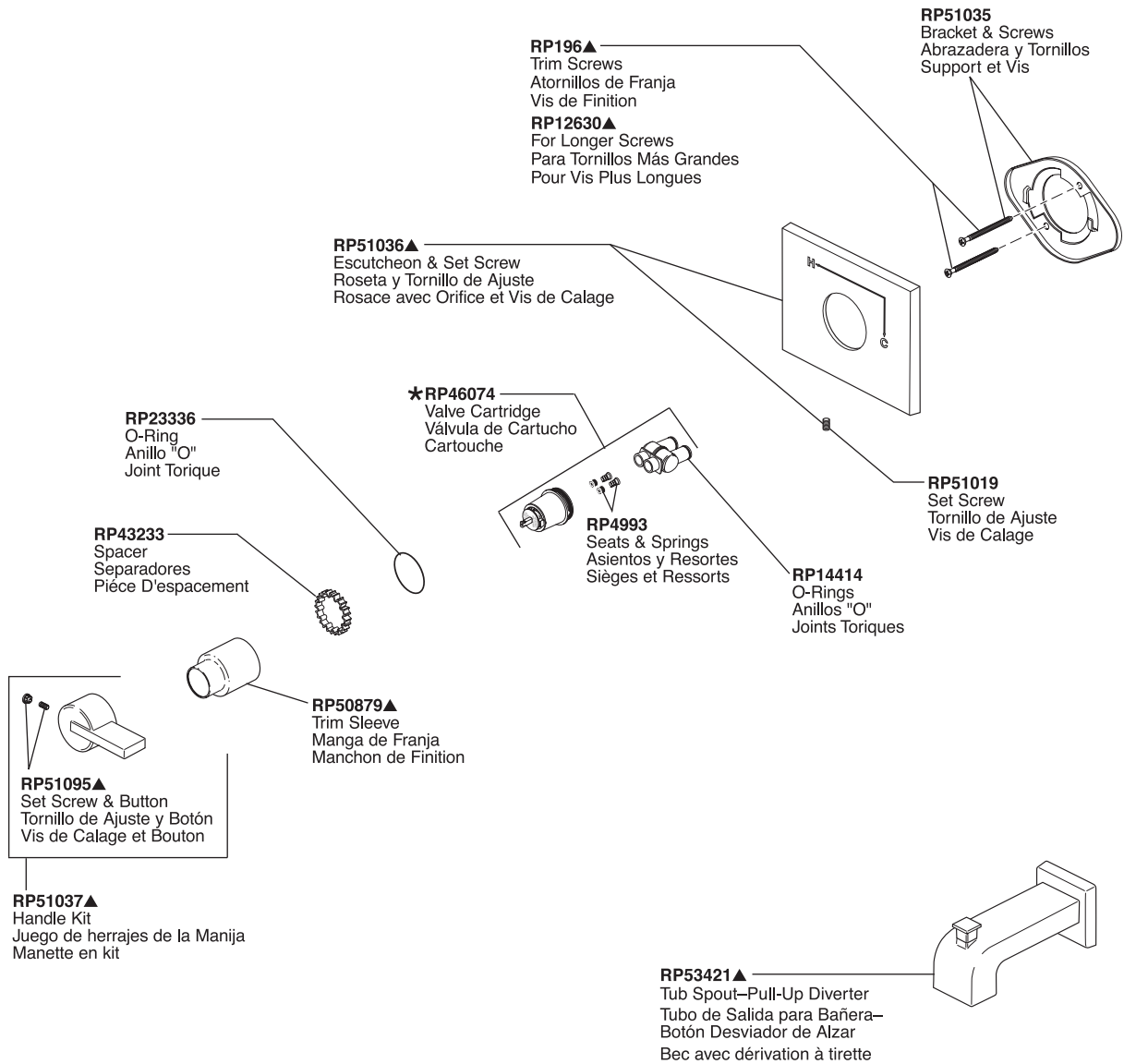
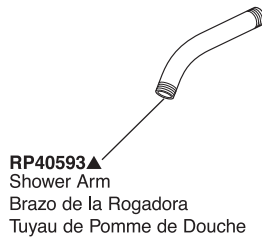
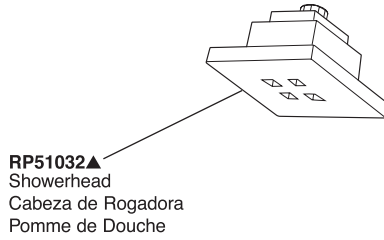

Cartridge Summary Reference Sheet

Units shipped in March 2006 and after.

MultiChoice® 13/14

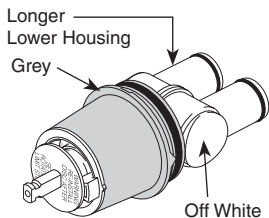

Order RP46074 to Replace Cartridge.

Units shipped before March 2006.

Old Monitor® 1300/1400

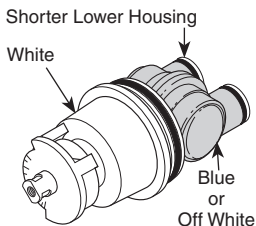

Order RP19804 to Replace Cartridge.

Replacement cartridges shipped in July 2006 and after.

New Monitor® 1300/1400

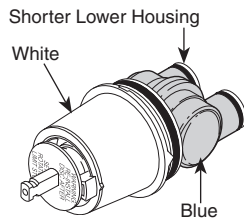

Order RP19804 to Replace Cartridge.

17

Grey Upper Cap

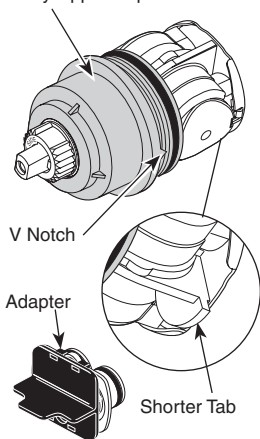

Order RP46463 to Replace Cartridge.

1700

White Upper Cap

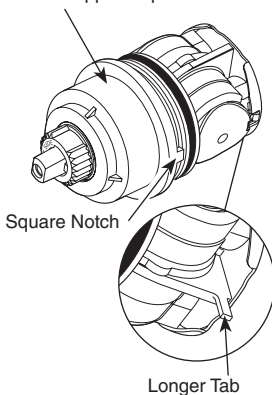

Order RP32104 to Replace Cartridge.

NA

17T

Brass

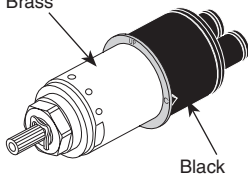

Order RP47201 to Replace Cartridge.

NA
Will Not Fit

NA