

Air Moving Components

MARS SERIES **400**



3 Wing Adapter Heavy Duty Condenser Fan Blades

airMARS 3 wing adapter, heavy duty condenser fan blades are designed for rigorous R/HVAC low pressure applications. They will accommodate universal hex/round adapter hubs. airMARS adapter fan blades are durable, efficient & quiet. They are manufactured using high strength aluminum alloy for the blades & sturdy steel for the blade spiders.

Blade depths and pitches specified for airMARS adapter fan blades allow for the replacement of a broad range of commonly used fan blades.

Typical applications are:

- Air Cooled Condensers
- Residential Air Conditioners
- Heat Pumps
- Roof Top Air Conditioners
- Power Roof Ventilators
- Unit Heaters
- Fan Coil Units

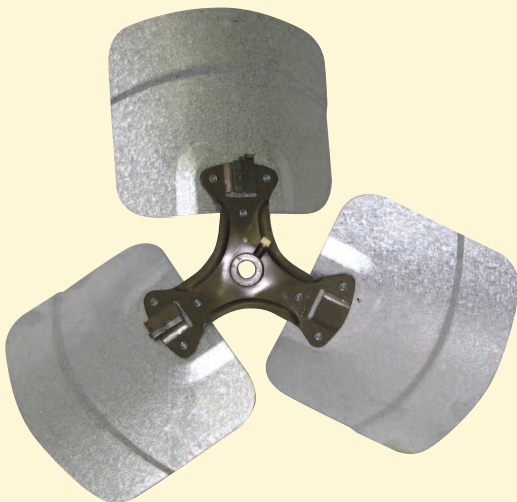

Universal Hex Adapter Hubs on page AM-21

MARS NO.	MODEL NO.	BLADE DIA.	PITCH DEG.	BLADE DEPTH	Static Pressure .10"			Static Pressure .30"			MARS PACK
					RPM	CFM	BHP	RPM	CFM	BHP	
40027	1027-3CW	10	27	2.19	825	104	0.006	825	N.A.	N.A.	2
					1075	241	0.01	1075	N.A.	N.A.	
					1725	572	0.03	1725	336	0.05	
40061	1219-3CW	12	19	1.56	825	121	0.008	825	N.A.	N.A.	2
					1075	295	0.01	1075	N.A.	N.A.	
					1725	625	0.04	1725	429	0.05	
40029 40030	1223-3CW 1223-3CCW	12	23	1.88	825	209	0.01	825	N.A.	N.A.	2
					1075	385	0.02	1075	N.A.	N.A.	
					1725	769	0.05	1725	580	0.07	
40031	1227-3CW	12	27	2.19	825	289	0.01	825	N.A.	N.A.	2
					1075	468	0.02	1075	N.A.	N.A.	
					1725	914	0.07	1725	714	0.09	
40033 40034	1423-3CW 1423-3CCW	14	23	2.67	825	568	0.02	825	N.A.	N.A.	2
					1075	892	0.04	1075	N.A.	N.A.	
					1725	1573	0.16	1725	1387	0.17	
40035 40036	1427-3CW 1427-3CCW	14	27	3.06	825	664	0.03	825	N.A.	N.A.	2
					1075	1006	0.05	1075	531	0.08	
					1725	1757	0.21	1725	1568	0.23	
40063	1619-3CW	16	19	2.56	825	610	0.02	825	N.A.	N.A.	2
					1075	1017	0.05	1075	305	0.06	
					1725	1811	0.17	1725	1549	0.20	
40037 40038	1622-3CW 1622-3CCW	16	22	2.94	825	748	0.03	825	N.A.	N.A.	2
					1075	1164	0.06	1075	481	0.08	
					1725	2039	0.23	1725	1815	0.25	
40039 40040	1627-3CW 1627-3CCW	16	27	3.56	825	1064	0.05	825	110	0.06	2
					1075	1525	0.10	1075	969	0.11	
					1725	2601	0.39	1725	2401	0.41	
40041 40042	1823-3CW 1823-3CCW	18	23	3.70	825	1202	0.06	825	464	0.10	2
					1075	1870	0.10	1075	972	0.13	
					1725	2487	0.32	1725	2629	0.33	

MAX RPM 10"- 18" DIA. 1725 RPM

continued on next page