



# ENGINEERING EXCELLENCE

Bellaire Series #3BL100

PARTS BREAKDOWN SHEET

### DESCRIPTION

- Two Handle Lavatory Faucet
- Metal Lever Handles
- 4-5/16" Reach, 2-7/8" from Deck to Aerator
- Ceramic Disc Cartridges
- 3-Hole 4" Installation
- Brass Pop-Up Drain Assembly

### FINISHES

- PC PVD Polished Chrome
- BN PVD Brushed Nickel
- ORB Oil Rubbed Bronze
- SS PVD Stainless Steel
- PN PVD Polished Nickel
- PB PVD Polished Brass



### STANDARDS APPLICABLE

- ASME A112.18.1
- ANSI A117.1
- ANSI / NSF 61, SECTION 9
- CUPC / IAPMO LISTED / ADA COMPLIANT
- CONTAINS NO MORE THAN 0.25% WEIGHTED AVERAGE LEAD CONTENT

### FLOW

- Aerator Limited to 1.5 GPM

#3BL100 SHOWN \* ADA



Model #: \_\_\_\_\_

Specific Features: \_\_\_\_\_

Project Name: \_\_\_\_\_

Submitted For: \_\_\_\_\_

| Model   | Description                                  | Finishes                    |                                  |
|---------|--|-----------------------------|----------------------------------|
| #3BL100 | Two Handle Lavatory Faucet                   | <input type="checkbox"/> PC | <input type="checkbox"/> Other__ |
| #3BL101 | Two Handle Lavatory Faucet-Less Pop-Up Drain | <input type="checkbox"/> PC | <input type="checkbox"/> Other__ |



ENGINEERING EXCELLENCE

Pioneer: 1-800-338-9468  
 Commerce, CA 90040  
 www.pioneerind.com  
 Pioneer Industries, Inc. © 2012

DMPB3BL100/REV. 04 2012  
 Page 1 of 2

|   | ITEM#        | DESCRIPTION                 |
|---|--------------|-----------------------------|
| A | X-1300016*   | Metal Lavatory Handle       |
| B | X-4900007    | Bonnet Nut                  |
| C | X-3900002C,H | Ceramic Stem - Cold, Hot    |
| D | X-4300075*   | 1.5 GPM Aerator             |
| E | X-4300076    | Base Gasket                 |
| F | X-4900008    | Mounting Kit                |
| G | X-4900004    | Supply Nut                  |
| H | X-6300025*   | Brass Pop-Up Drain Assembly |
| 1 | X-4300077*   | Hole Cover                  |
| 2 | X-4900015    | Screw                       |

\* Note- Please specify finish/color code while ordering.

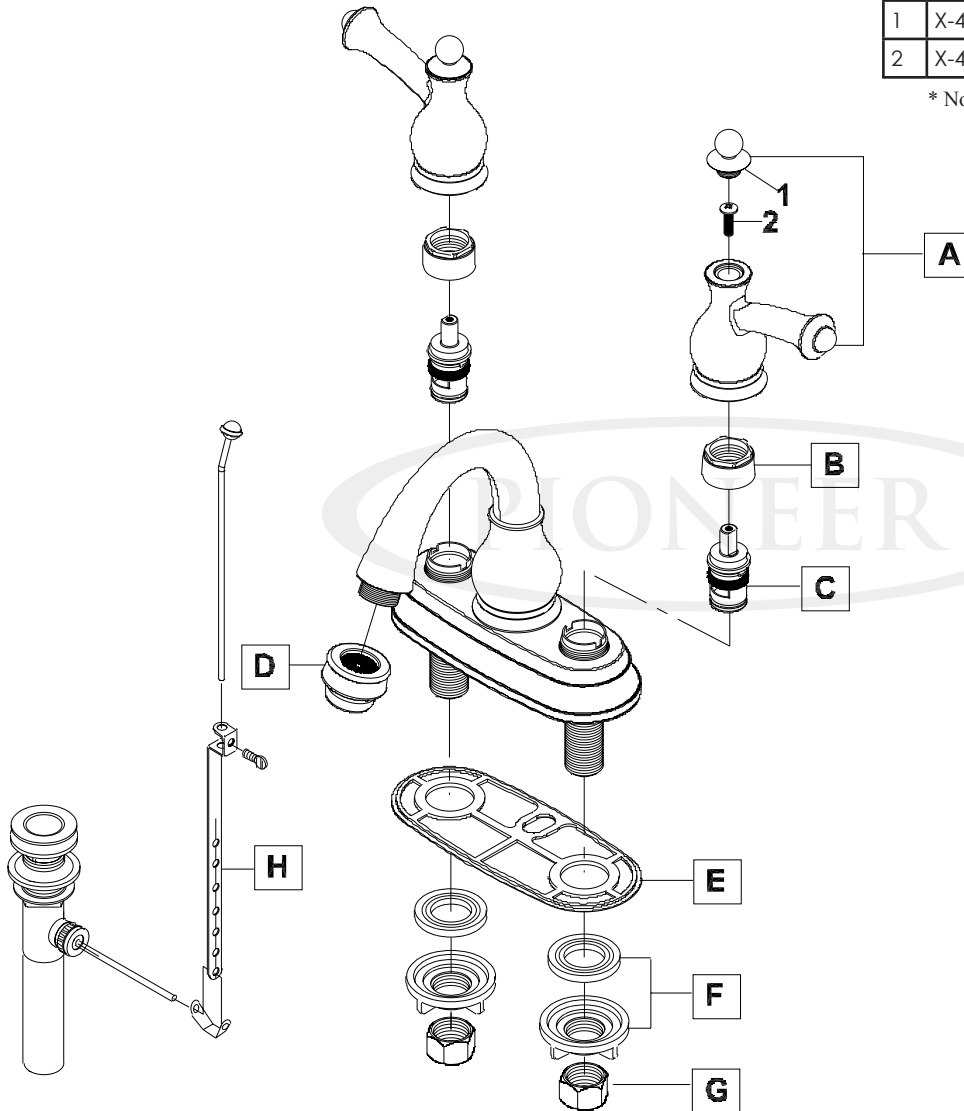

Product Diagram



ENGINEERING EXCELLENCE

Pioneer: 1-800-338-9468  
 Commerce, CA 90040  
 www.pioneerind.com  
 Pioneer Industries, Inc. © 2012