



# ENGINEERING EXCELLENCE

Prenza Series #4PR610T

PARTS BREAKDOWN SHEET

### DESCRIPTION

- Two Handle Roman Tub Trim Set
- Metal Lever Handles
- Rigid Spout
- 10" Reach
- 3-Hole 8" to 16" Installation

### FINISHES

- PC PVD Polished Chrome
- BN PVD Brushed Nickel
- SS PVD Stainless Steel
- PN PVD Polished Nickel



#4PR610T SHOWN \* ADA 

### STANDARDS APPLICABLE

- ASME A112.18.1
- ANSI A117.1
- CUPC / IAPMO LISTED / ADA COMPLIANT

Model #: \_\_\_\_\_

Specific Features: \_\_\_\_\_

Project Name: \_\_\_\_\_

Submitted For: \_\_\_\_\_

Model	Description	Finishes
#4PR610T	Two Handle Roman Tub Trim Set	<input type="checkbox"/> PC <input type="checkbox"/> Other__
Required Valve		
#4300B	Two Handle Roman Tub Valve Set	<input type="checkbox"/> N/A



ENGINEERING EXCELLENCE

Pioneer: 1-800-338-9468  
 Commerce, CA 90040  
 www.pioneerind.com  
 Pioneer Industries, Inc. © 2013

DMPB4PR610T/REV. 12 2012  
 Page 1 of 2

	ITEM#	DESCRIPTION
A	X-1400019*	Prenza Handle
B	X-4400069	Handle Locknut
C	X-4900053	Stem Extension
D	X-2400002*	Spout
E	X-4900077	Mounting Tool
1	X-4400027*	Flow Streamer
2	X-4400058	5/16" Allen Wrench
3	X-4400028	5/16" Allen Screw
4	X-4900044*	Hole Cover
5	X-4400034*	Spout Escutcheon

\* Note- Please specify finish/color code while ordering.

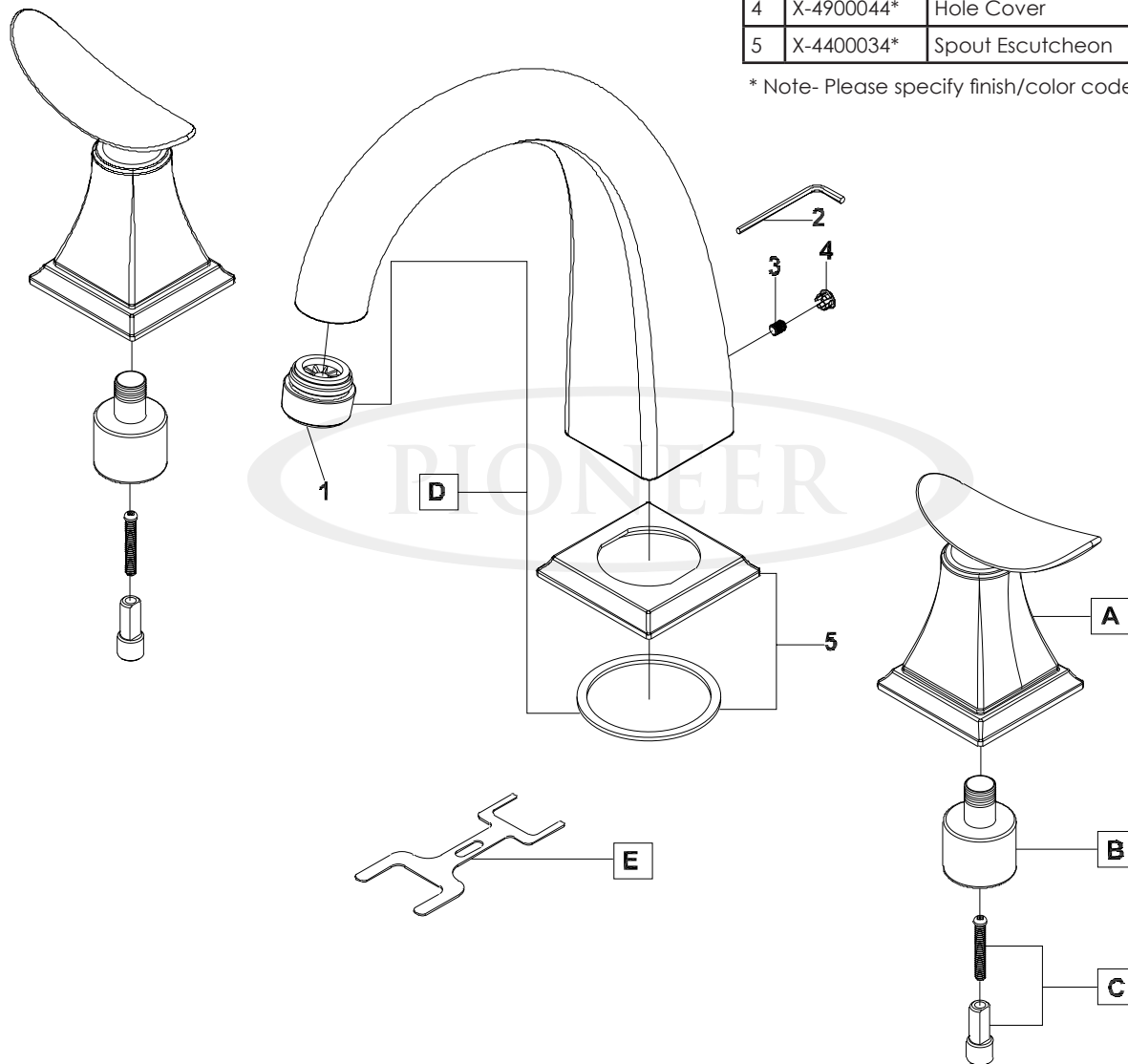

Product Diagram



ENGINEERING EXCELLENCE

Pioneer: 1-800-338-9468  
 Commerce, CA 90040  
 www.pioneerind.com  
 Pioneer Industries, Inc. © 2013