



# ENGINEERING EXCELLENCE

## Motegi Series #6MT410 PARTS BREAKDOWN SHEET

### DESCRIPTION

- Handheld Shower Set
- Single Function Handheld Showerhead
- 60" Stainless Steel Flex Hose
- Wall Mount Bracket with Vacuum Breaker

### FINISHES

- PC PVD Polished Chrome
- BN PVD Brushed Nickel
- PB PVD Polished Brass
- PN PVD Polished Nickel
- SS PVD Stainless Steel
- ORB Oil Rubbed Bronze

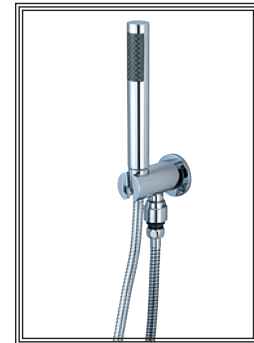

#6MT410 SHOWN \* ADA 

### STANDARDS APPLICABLE

- ASME A112.18.1
- ANSI A117.1
- ADA COMPLIANT
- **Note:-** This Product Complies With ADA Requirement For Lever Handle.

### FLOW

- Showerhead Limited to 2.5 GPM

Model #: \_\_\_\_\_

Specific Features: \_\_\_\_\_

Project Name: \_\_\_\_\_

Submitted For: \_\_\_\_\_

Model	Description	Finishes
#6MT410	Handheld Shower Set	<input type="checkbox"/> PC <input type="checkbox"/> Other ____



ENGINEERING EXCELLENCE

Pioneer:1-800-338-9468  
 Commerce, CA 90040  
 www.pioneerind.com  
 Pioneer Industries, Inc. © 2013

DMPB6MT410/REV. 12 2012  
 Page 1 of 2

	ITEM#	DESCRIPTION
A	X-4900049*	Motegi Handheld Shower Set-2.5 GPM
B	X-4600006*	60" Stainless Steel Flex Hose
C	X-4600005*	Vacuum Breaker
D	X-4600031*	Drop Ell with Handheld Support
E	X-4600032*	Flange
1	X-4900050	Rubber Washer

\* Note: Please specify finish/color when ordering.

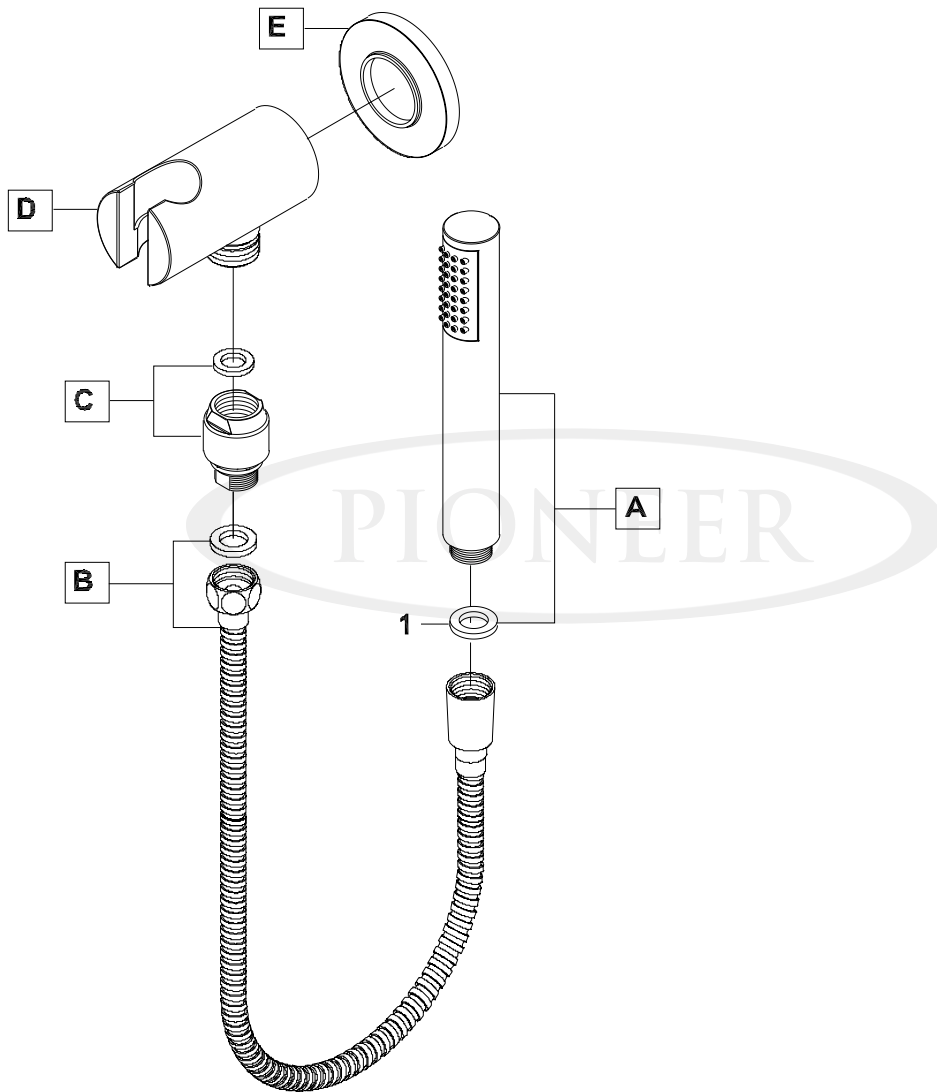

Product Diagram



ENGINEERING EXCELLENCE

Pioneer: 1-800-338-9468  
 Commerce, CA 90040  
 www.pioneerind.com  
 Pioneer Industries, Inc. © 2013