



# ENGINEERING EXCELLENCE

Brentwood Series #3BR410

PARTS BREAKDOWN SHEET

### DESCRIPTION

- Two Handle Lavatory Wide-spread Faucet
- Porcelain Lever Handles
- Rigid J Style Spout
- 4-9/16" Reach, 4-1/2" from Deck to Aerator
- Ceramic Disc Cartridges
- 3-Hole 6" to 16" Installation
- Brass Pop-Up Drain Assembly
- Includes Spout and Valve Escutcheons

### FINISHES

- PC PVD Polished Chrome
- BN PVD Brushed Nickel
- PN PVD Polished Nickel
- PB PVD Polished Brass
- ORB Oil Rubbed Bronze



#3BR410 SHOWN \* ADA 

### STANDARDS APPLICABLE

- ASME A112.18.1
- ANSI A117.1
- ANSI / NSF 61, SECTION 9
- CUPC / IAPMO LISTED / ADA COMPLIANT
- CONTAINS NO MORE THAN 0.25% WEIGHTED AVERAGE LEAD CONTENT

### FLOW

- Aerator Limited to 1.5 GPM

Model #: \_\_\_\_\_

Specific Features: \_\_\_\_\_

Project Name: \_\_\_\_\_

Submitted For: \_\_\_\_\_

Model	Description	Finishes	
#3BR410	Two Handle Lavatory Widespread Faucet	<input type="checkbox"/> PC	<input type="checkbox"/> Other ____



ENGINEERING EXCELLENCE

Pioneer: 1-800-338-9468  
 Commerce, CA 90040  
 www.pioneerind.com  
 Pioneer Industries, Inc. © 2013

ITEM#	DESCRIPTION
A	X-1900010C,H* Porcelain Lever Handle-Cold,Hot
B	X-4900063* Valve Escutcheon
C	X-5900001 Mounting Kit
D	X-4900022 Bonnet Nut
E	X-3900002C,H Ceramic Disc Cartridge-Cold,Hot
F	X-4900004 Supply Nut
G	X-4300011 'Y' Connector
H	X-5300003 Spout Mounting Kit
I	X-2300009* 'J' Style Spout
J	X-6300008* Brass Pop-Up Drain Assembly
1	X-4900042C,H* Button-Cold,Hot
2	X-4900061 Brentwood Handle Screw
3	X-4900081* 1.5 GPM Aerator
4	X-4300035* Spout Escutcheon
5	X-4300045* Pop-Up Lift Rod

\* Note- Please Specify finish\color code while ordering.

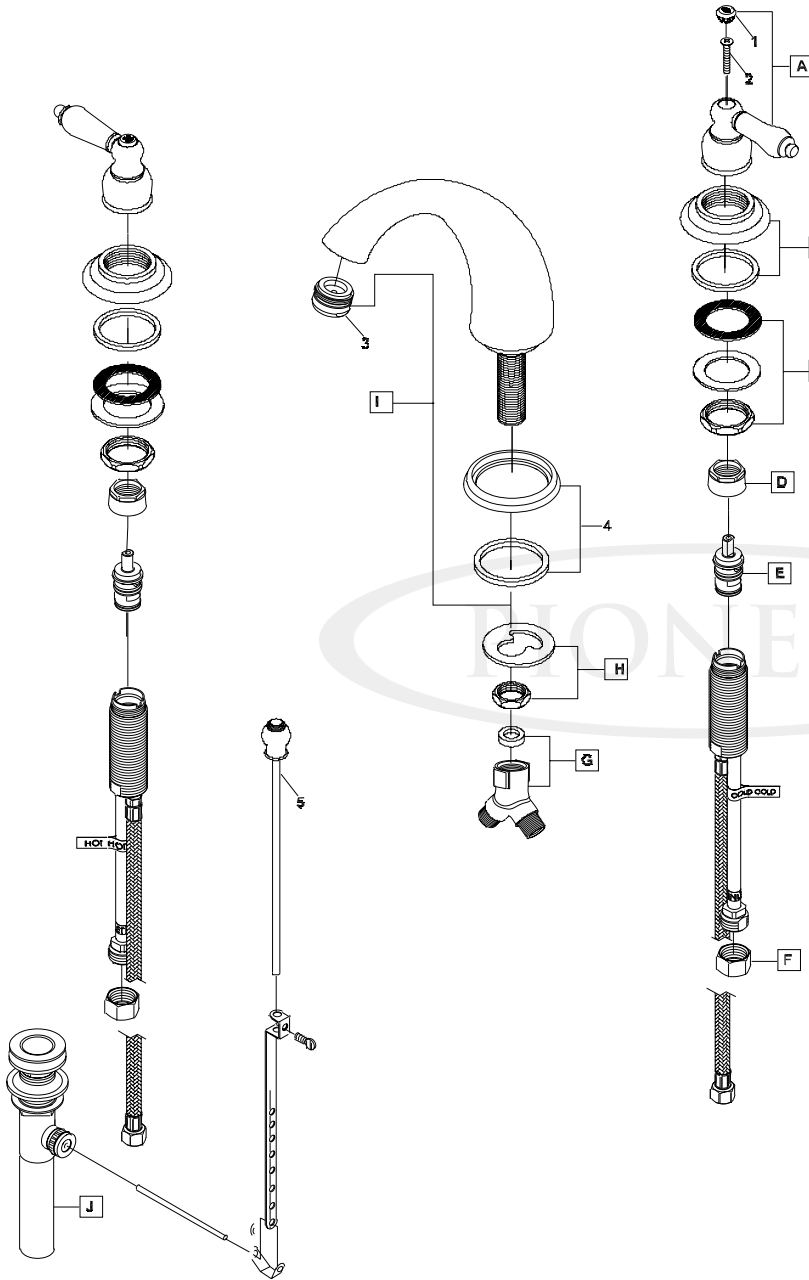

Product Diagram



ENGINEERING EXCELLENCE

Pioneer:1-800-338-9468

Commerce, CA 90040

www.pioneerind.com

Pioneer Industries, Inc. © 2013