



# ENGINEERING EXCELLENCE

Americana Series #3AM100

PARTS BREAKDOWN SHEET

### DESCRIPTION

- Two Handle Lavatory Faucet
- Metal Lever Handles
- Rigid Spout
- 5-1/2" Reach, 4-1/2" from Deck to Aerator
- Ceramic Disc Cartridges
- 3-Hole 4" Installation
- Brass Pop-Up Drain Assembly

### FINISHES

- PC PVD Polished Chrome
- BN PVD Brushed Nickel
- SS PVD Stainless Steel
- PN PVD Polished Nickel
- PB PVD Polished Brass
- GR PVD Golden Rose
- ORB Oil Rubbed Bronze
- TB PVD Tuscany Bronze



#3AM100 SHOWN \* ADA 

### STANDARDS APPLICABLE

- ASME A112.18.1
- ANSI A117.1
- ANSI / NSF 61, SECTION 9
- CUPC / IAPMO LISTED / ADA COMPLIANT
- CONTAINS NO MORE THAN 0.25% WEIGHTED AVERAGE LEAD CONTENT

### FLOW

- Aerator Limited to 1.5 GPM



Model #: \_\_\_\_\_

Specific Features: \_\_\_\_\_

Project Name: \_\_\_\_\_

Submitted For: \_\_\_\_\_

Model	Description	Finishes
#3AM100	Two Handle Lavatory Faucet	<input type="checkbox"/> PC <input type="checkbox"/> Other _____



ENGINEERING EXCELLENCE

Pioneer: 1-800-338-9468  
 Commerce, CA 90040  
 www.pioneerind.com  
 Pioneer Industries, Inc. © 2013

	ITEM#	DESCRIPTION
A	X-1300004C,H*	Lever Handle-Cold, Hot
B	X-4900037	Bonnet Nut
C	X-4900038	Gasket
D	X-3900004C,H	Ceramic Cartridge-Cold,Hot
E	X-4300018	Base Gasket
F	X-4900008	Mounting Kit
G	X-4900004	Supply Nut
H	X-4900091*	1.5 GPM Aerator
I	X-6300005*	Brass Pop-Up Drain Assembly
1	X-4900042C,H*	Handle Button-Cold,Hot
2	X-4900036	Handle Screw

\* Note- Please specify finish/color code while ordering.

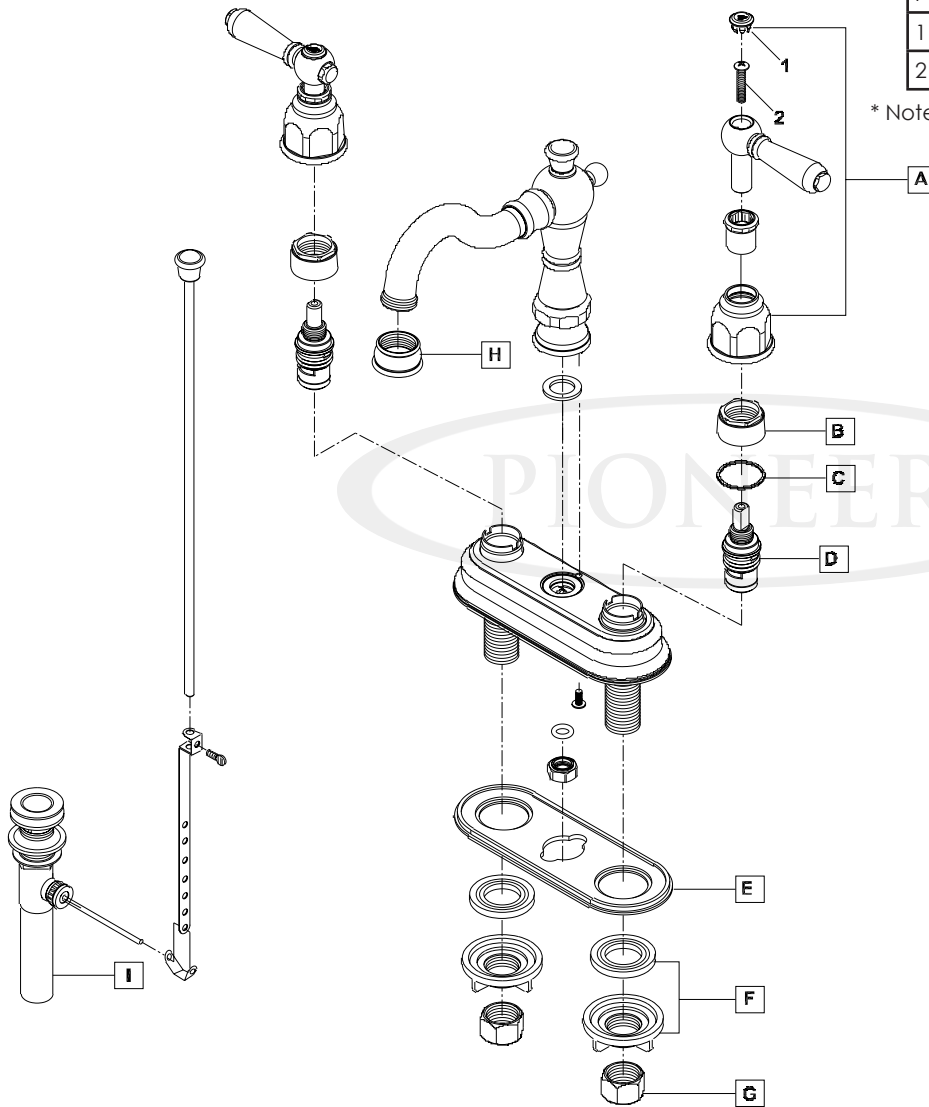

Product Diagram



ENGINEERING EXCELLENCE

Pioneer:1-800-338-9468  
Commerce, CA 90040  
www.pioneerind.com  
Pioneer Industries, Inc. © 2013