

Manufactured from Swanstone solid surface
 (see page 2 for detailed information)

Recommended for high use traffic areas and commercial surfaces

WARRANTY

Limited Lifetime – Residential
 Limited 10-year – Commercial

FEATURES

- Reinforced solid surface means color and texture run all the way through and cannot wear away
- Mounts underneath your choice of countertop for high-design appeal
- Heat, stain, and scratch resistant for lasting beauty
- Available in a wide variety of solid and granite colors
- Matching or contrasting countertops available. Contact a Swanstone representative for more information.

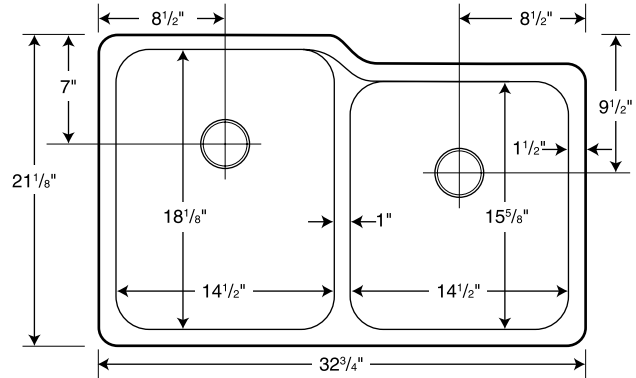
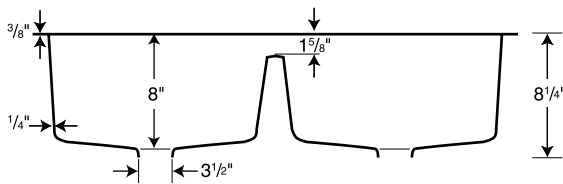

SPECIFICATIONS

US-3015 Double Bowl

Model	Part	Dimensions	Ship Wt. Lb.	Ship UPS	Carton Dims. In.	Cu. Ft.
US-3015	US03015SB	32-3/4" W x 21-1/8" D (832 mm x 539 mm)	39	UPS	37 x 24 x 13	6.68

COLORS

(See inside back cover for color sample.)

- White (010)
- Bone (037)
- Bisque (018)
- Almond Galaxy (046)
- Arctic Granite (035)
- Barley (091)
- Bermuda Sand (040)
- Gray Granite (042)
- Green Pasture (095)
- Sierra (094)
- Tahiti Blue (056)
- Tahiti Desert (050)
- Tahiti Evergreen (057)
- Tahiti Gray (053)
- Tahiti Ivory (059)
- Tahiti Matrix (058)
- Tahiti Rose (052)
- Tahiti Sand (051)
- Tahiti Terra (055)
- Tahiti White (011)
- Cornflower (063)
- Ironweed (061)
- Night Sky (012)
- Purple Sage (064)
- Wild Indigo (022)
- Winter Wheat (060)
- Indian Grass (071)
- Black Galaxy (015)
- Pebble (072)
- Seafoam (074)
- Glacier (121)
- Prairie (122)
- Acorn (123)
- Canyon (124)
- Baby's Breath (168)
- Caraway Seed (169)

STANDARDS AND RATINGS

Class 1A fire rating

American National Standard Institute—ANSI Z124.6

International Association of Plumbing and Mechanical Officials (IAPMO)—listed

cUPC listed—Certified to CSA Standard B45 by IAPMO

National Sanitation Foundation-NSF Splash Zone, -NSF Food Zone

American Society for Testing and Materials

National Electrical Manufacturers Association

For a complete list of tests and results see the Technical Data Sheet – page 131.

SUPPORT DOCUMENTS

Installation instructions available on line at www.swanstone.com

 **MADE IN USA.**

MAINTENANCE AND CLEANING INFORMATION

Clean your Swanstone sink by using abrasive cleaners such as Comet, Ajax, Bon Ami, Soft Scrub, etc. Use of a Scotch-Brite pad, nylon scrub pad, or Mr. Clean Magic Eraser is also recommended. Food based stains can be removed using a 50/50 bleach and water solution and soaking for 15 minutes. For rust or other mineral based stains, products such as Rust-Out or Whink are acceptable. To restore luster and extend time between cleanings, Weiman's Granite Polish is recommended. **Do not** use SOS, Brillo or other metal scouring pads.