

# Tubular Plastic

## Innovator® 590

For most tubs 14" - 16" high

1.5" Tubular Plastic Bath Wastes  
Slip-Joint Assembly  
Now Coarse Thread

### SPECIFICATIONS

#### FEATURES:

- Eliminates all screws
- Eliminates leaks due to loose overflow attachment
- Eliminates dual inventory of one- and two-hole overflow plates; saves time on installation

#### APPROVALS:

- Manufactured in compliance with ASME A112.18.2-2005/CSA B125.2-2005.
- Manufactured in compliance with ASTM F 409-2002 and NSF/ANSI 14-2007.

#### PATENTS:

- <https://www.watcomfg.com/patents>

#### THREAD SIZE (Strainer Body and Drain Elbow):

- 1.865" - 11.5 NPSM (Coarse Thread)

PIPING:  PVC  ABS

#### ROUGH-IN (RI's) and STOPPER/FACEPLATE (SF's)



Snap-on overflow plate.  
No screws



**ADA**

PRESFLO® (PF)  
Foot Actuated (FA) only

See price list for complete item numbers and available options.

When ordering, please specify complete item number and any applicable option codes.

**WATCO**



For More Information Contact:  
**WATCO Manufacturing Company**  
1220 South Powell Road  
Independence, MO 64057-2724  
Ph. 816-796-3900 • FAX 816-796-0875  
[www.watcomfg.com](http://www.watcomfg.com)

Always a step ahead

#### STOPPER/FACEPLATE'S (example: 590-LTSF-0-CP)

Made up of the overflow plate and stopper assembly; NO strainer body.  
(See next page for available stopper assemblies.)

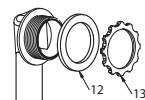
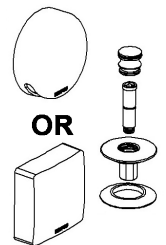

11

8

9

10

5

6

7

15

16

#### ROUGH-IN'S (example: 590-LTRI-PVC-CP)

Made up of all parts, including strainer body, except the overflow plate and stopper assembly

12

13