



# ENGINEERING EXCELLENCE

Americana Series #4AM300T

PARTS BREAKDOWN SHEET

### DESCRIPTION

- Single Handle Shower Trim Set
- Metal Lever Handle
- Ceramic Disc Cartridge with Temperature Limit Stop
- Single Function 3-1/2" Diameter Showerhead
- 13" Long Shower Arm and Flange
- Color Match Sleeve and Retaining Ring

### FINISHES

- PC PVD Polished Chrome
- BN PVD Brushed Nickel
- SS PVD Stainless Steel
- PN PVD Polished Nickel
- PB PVD Polished Brass
- GR PVD Golden Rose
- ORB Oil Rubbed Bronze



#4AM300T SHOWN \* ADA 

### STANDARDS APPLICABLE

- ASME A112.18.1
- ANSI A117.1
- CUPC / IAPMO LISTED / ADA COMPLIANT

### FLOW

- Showerhead Limited to 1.75 GPM Flow Rate



Certified by IAPMO R&T

Model #: \_\_\_\_\_

Specific Features: \_\_\_\_\_

Project Name: \_\_\_\_\_

Submitted For: \_\_\_\_\_

Model	Description	Finishes
#4AM300T	Single Handle Tub and Shower Trim Set	<input type="checkbox"/> PC <input type="checkbox"/> Other ____
Required Valve		
#4020B	Single Handle Tub And Shower Valve Set	<input type="checkbox"/> N/A



ENGINEERING EXCELLENCE

Pioneer: 1-800-338-9468  
 Commerce, CA 90040  
 www.pioneerind.com  
 Pioneer Industries, Inc. © 2013

DMPB4AM300T/REV. 12 2012

Page 1 of 2

	ITEM#	DESCRIPTION
A	X-6400006*	Shower Arm Flange
B	X-6400005*	Shower Arm
C	X-6400097*	Showerhead
D	X-3400007	Ceramic Disc Cartridge
E	X-4400030*	Sleeve
F	X-4400080	Lock Nut
G	X-4200001*	Retainer Cap
H	X-6400007*	Face Plate
I	X-1400029*	Lever Handle
1	X-4900042P*	Hole Cover
2	X-4400021	Gasket
3	X-4400022	Face Plate Rubber Gasket

\* Note- Please specify finish\color code while ordering.

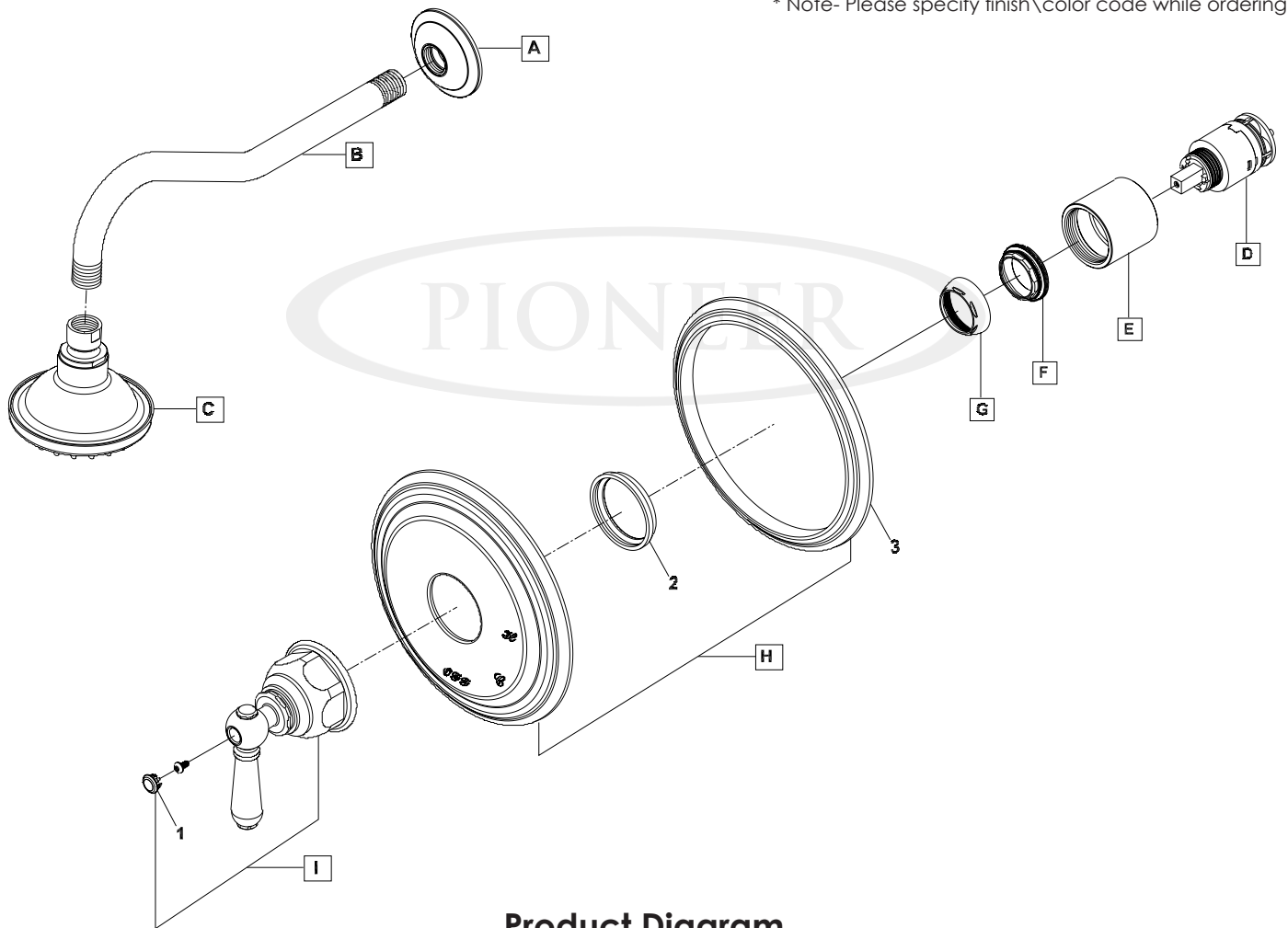

Product Diagram



ENGINEERING EXCELLENCE

Pioneer:1-800-338-9468  
Commerce, CA 90040  
www.pioneerind.com  
Pioneer Industries, Inc. © 2013