

1

DRAIN

The **NEW 1 DRAIN** takes all the benefits of multiple drains and combines them into **1**

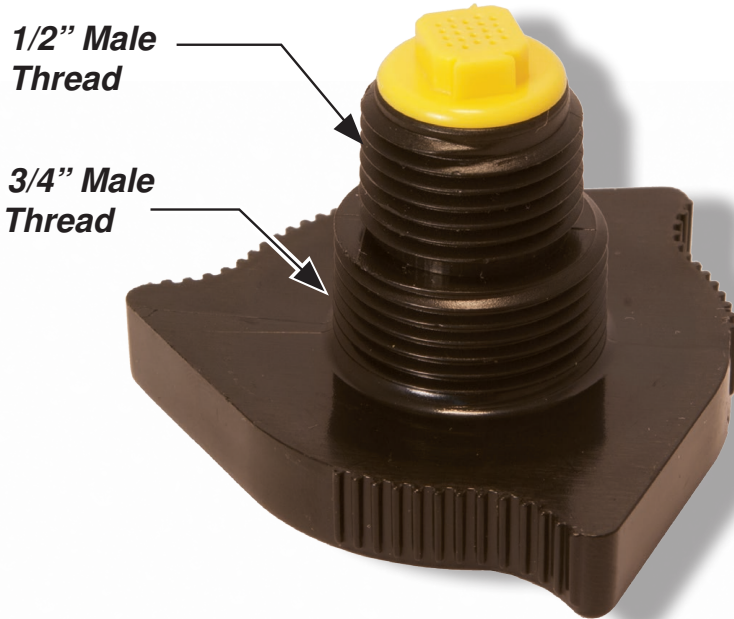

1/2" Male Thread

3/4" Male Thread

1 Instructions to Change **OD-1 DRAIN** to 3/4" MPT:

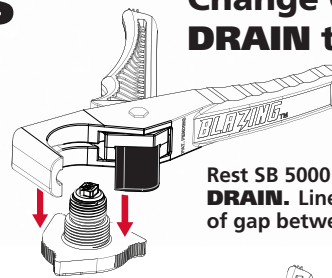

Rest SB 5000 Cutter on bottom of **OD-1 DRAIN**. Line up blade so it is in the middle of gap between threads.

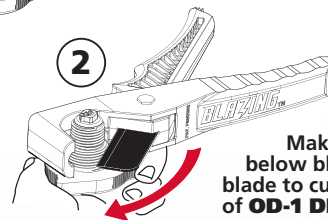

Hold drain tightly. Make sure fingers are below blade. Then rotate blade to cut off top portion of **OD-1 DRAIN**

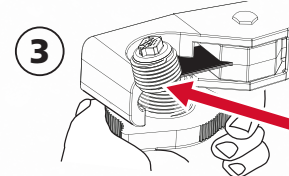

Discard top portion of **OD-1 DRAIN**

Option #1
1/2" MPT
OD-1 DRAIN

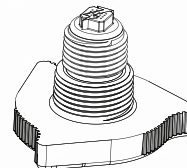

Option #2
3/4" MPT
OD-1 DRAIN

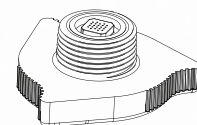

PART	DESCRIPTION	PACKAGE	CARTON	MIN. ORDER
Lateral Line or Main Line Do not use pipe dope for sealant				
OD 1	1/2" MPT or 3/4" MPT	25	400 or 800	25

MADE IN CHINA

Use only in accordance with local and national codes. US Patents 5,640,991; 5,694,241. All other appropriate trademarks, U.S. and Foreign Patents apply. Printed in USA. ©2015 Blazing Products, Inc.

Blazing Products, Inc.
St. Louis, Missouri USA

www.BlazingProducts.com

BLAZING
INSTALL FASTER.