

1930 Toilet wall-mounted # 0182090092 / 01820900921

|< 14" Inch >|

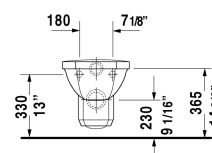
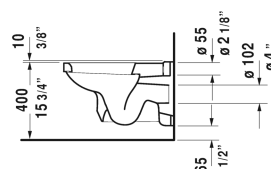
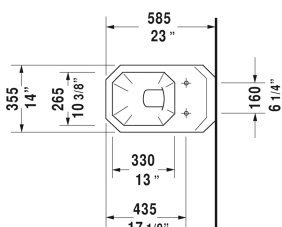

Toilet wall-mounted	Dimension	Weight	Order number
washdown model			
Colors			
00 White			
Variant			
♣ 1.6/0.8 gpf	14" x 22 7/8" Inch	47.4 lb	0182090092
♣ 1.6/0.8 gpf	14" x 22 7/8" Inch	47.4 lb	01820900921
Infobox			
In-wall tank & carrier and actuator plate required for installation / Refer to page XXX			
Hardware for wall-mounted bidet and wall-mounted toilet	Ø 1/2" x 7 1/8" Inch	0.4 lb	006500
Noise reduction gasket for wall-mounted toilet		0.7 lb	005020
Geberit in-wall tank and carrier width 19 3/4", depth 5 1/2" height (adjustable) 43" - 47"	19 3/4" x 5 1/2" Inch	38 lb	111335
Sigma 01 flush plate, dual flush White	9 5/8" x 6 1/2" Inch		115770
Suitable products			
Toilet seat and cover oval seat hole, hinges stainless steel, without slow close, 14 1/2" x 17" Inch	14 1/2" x 17" Inch		006661
Toilet seat and cover octagonal seat hole, hinges stainless steel, with slow close,			006489

All drawings contain the necessary measurements which are subject to standard tolerances. They are stated in inch & mm and are non-binding. Exact measurements, in particular for customized installation scenarios, can only be taken from the finished ceramic piece.