

PARTS LIST		
1	A54874	Orifice Assembly
2	A55066	Adapter
3	A54735	Flexi-Guard
4	45662C	Push Button
5	56087C	Nylon Rod
6	45458C	Push Button Sleeve
7	40045C	Hex Nut
8	61313C	Regulator
9	15005C	Retaining Nut
10	50986C	Regulator Holder
11	A54870	Washer
12	A51266	Lock Nut
13	160165816820	Tailpiece - Slip 1/4 NPT
14	P02103	Coupling Nut
15	75507C	Adapter
16	55996C	Strainer
17	56092C	Tube - Poly 1/4" x 72.00"
18	70022C	Screw-#6-32 x .31 Set (NS)

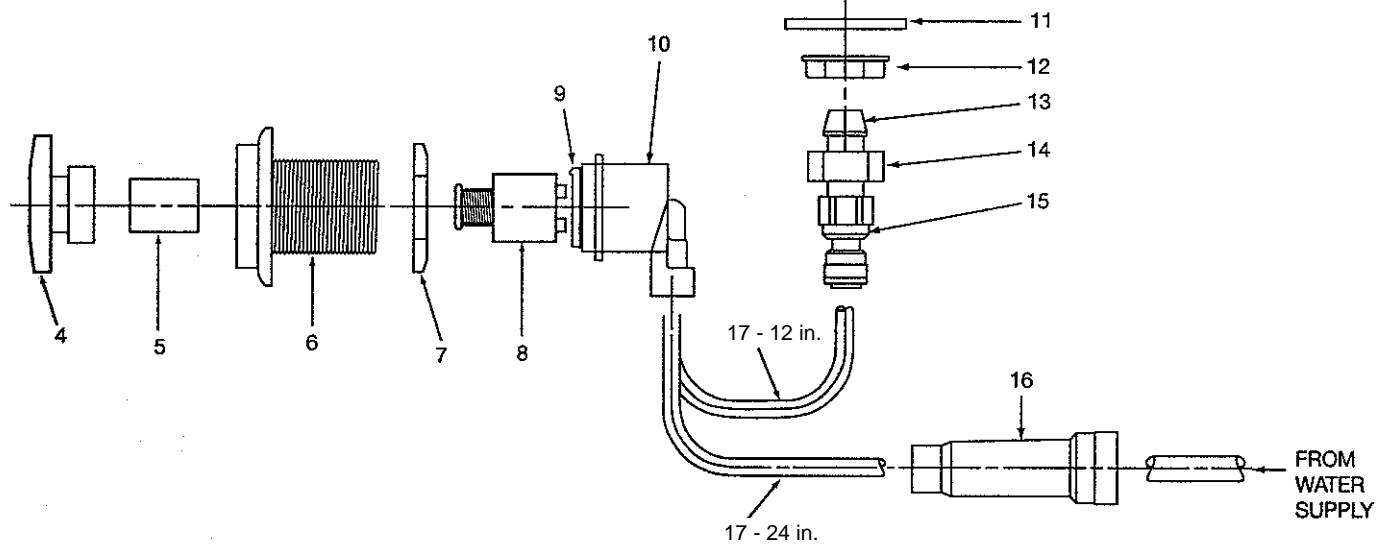

ATTENTION INSTALLER:
TO ASSURE YOU INSTALL THIS MODEL EASILY AND CORRECTLY, PLEASE READ THESE SIMPLE INSTRUCTIONS BEFORE STARTING THE INSTALLATION. CHECK YOUR INSTALLATION FOR COMPLIANCE WITH PLUMBING AND OTHER APPLICABLE CODES.

STEP 1

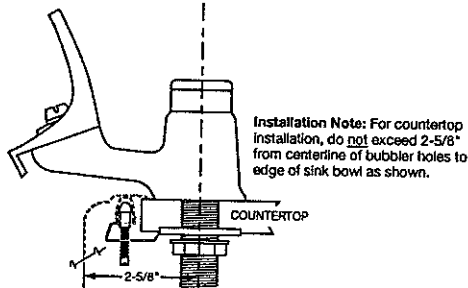

Determine location of bubbler and push button assembly.

STEP 2

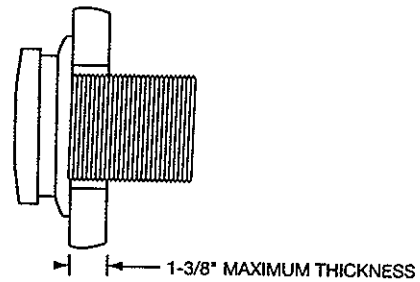

Place push button assembly in 1-1/2" hole. Tighten with hardware.

STEP 3

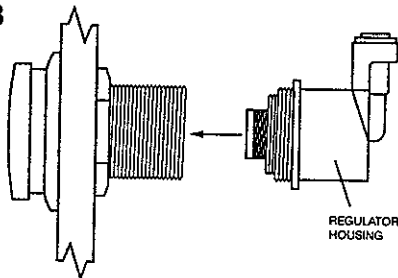

Carefully thread regulator/housing into bottom female thread of push button assembly. Hand tighten.

STEP 4

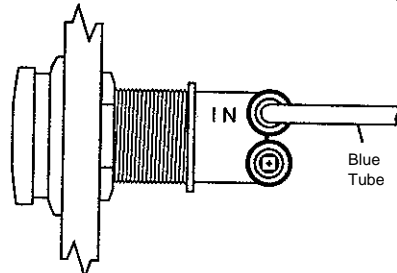

Insert 12" blue tube (included) into regulator part identified as "IN".

STEP 5

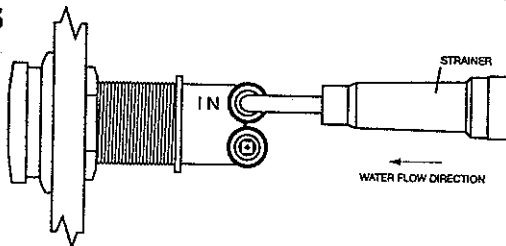

Attach in-line strainer to inlet side of 1/4" blue tube.

STEP 6

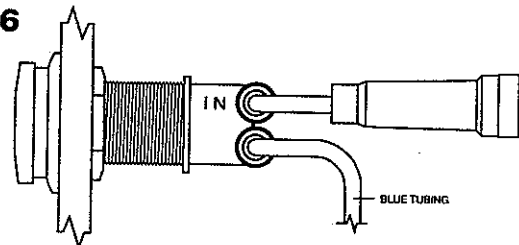

Firmly insert blue tubing into remaining available regulator port.

STEP 7

Connect blue tubing to bubbler. Connect 3/8" O.D. supply into strainer end. Turn water on and check for leaks.

