

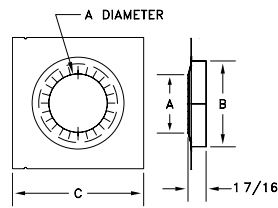

## FIRESTOP SUPPORT (CONTINUED)

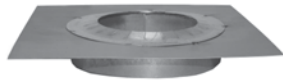

## Gripper Support - Round

- UL-listed as a support and firestop, the gripper support is strong enough to hold up to 30' of vent pipe
- Installs very quickly and allows for adjustment of the pipe to wherever needed
- A ring on the bottom provides the UL-required, one-inch clearance to combustibles (3" to 6" only; 7" to 10" are not UL-listed)
- No tools are required

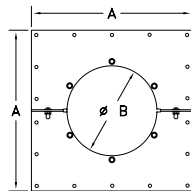

## Support Plate - Round

- Designed to provide strength and durability for supporting large size pipe sections, and serves as a firestop
- Supports up to 30'

PART #	PIPE SIZE	A	B	C
3EGS	3"	3 1/2"	5 1/2"	9"
4EGS	4"	4 1/2"	6 1/2"	10"
5EGS	5"	5 1/2"	7 1/2"	11"
6EGS	6"	6 1/2"	8 1/2"	12"
7EGS	7"	8"	10"	13"
8EGS	8"	9"	11"	14"
9EGS	9"	10"	12"	15"
10EGS	10"	11"	13"	16"

PART #	PIPE SIZE	A	B
9RSP	9"	17"	9 5/8"
10RSP	10"	18"	10 5/8"
12RSP	12"	20"	12 5/8"
14SP	14"	22"	14 5/8"
16SP	16"	24"	16 5/8"
18SP	18"	26"	18 5/8"
20SP	20"	28"	20 5/8"
22SP	22"	30"	22 5/8"
24SP	24"	32"	24 5/8"
26SP	26"	34"	26 5/8"
28SP	28"	36"	28 5/8"
30SP	30"	38"	30 5/8"

## WALL THIMBLE

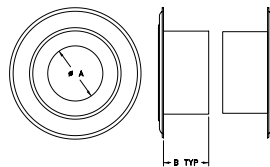

## Wall Thimble - Round

- Used to install pipe through an interior wall and provide proper clearance from combustibles
- The wall thimble adjusts for various wall thicknesses from 4" to 6"

PART #	SIZE	A	B
3EWT	3"	3 9/16"	3 1/16"
4EWT	4"	4 9/16"	3 1/16"
5EWT	5"	5 9/16"	3 1/16"
6EWT	6"	6 9/16"	3 1/4"
7RWT	7"	8 1/16"	3 1/4"
8RWT	8"	9 1/16"	3 1/4"
9RWT	9"	10 1/16"	3 1/4"
10RWT	10"	11 1/16"	3 1/4"
12RWT	12"	13 1/16"	3 1/4"