

# American Standard

---

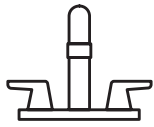

---

**American Standard is devoted to making life,  
in the heart of your home, better every day...**

...so, thank you for inviting us in! With the very best in kitchen and bathroom products, we are here to help make your life happier, healthier and simpler. Our commitment to quality, innovation and performance has made us part of your everyday routine for nearly 150 years, and we look forward to being a part of your life for many years to come.

**Learn more at [www.AmericanStandard.com](http://www.AmericanStandard.com)**

## **REGISTER YOUR WARRANTY**

Try the easy-scan **QR code** to quickly enter your information or find your product's detailed warranty here:

**[www.AmericanStandard.com/warranty](http://www.AmericanStandard.com/warranty)**



Registering allows you to keep your product information safe, and us the ability to contact you in the event of a product recall or *any* news about your purchase.

**And if ever you have a question or need help...?**

Call us at 1-855-815-0004

M965366 EN (7/23)

8337018/8337024/8337190/8337210/8337230

*American Standard*

# OWNERS MANUAL

## C Series Casual Bath Accessories

8337018 / 8337024 / 83370190 /  
8337210 / 8337230

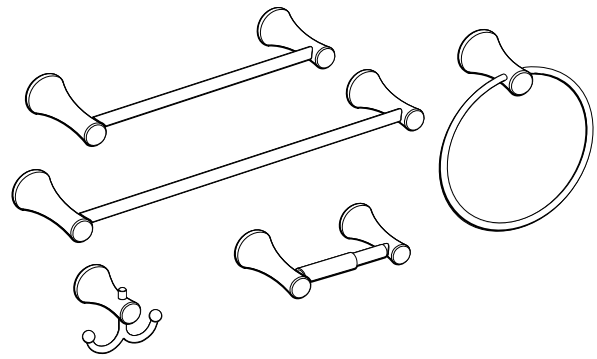

### INSIDE THE BOX

Image shown may vary from product purchased.

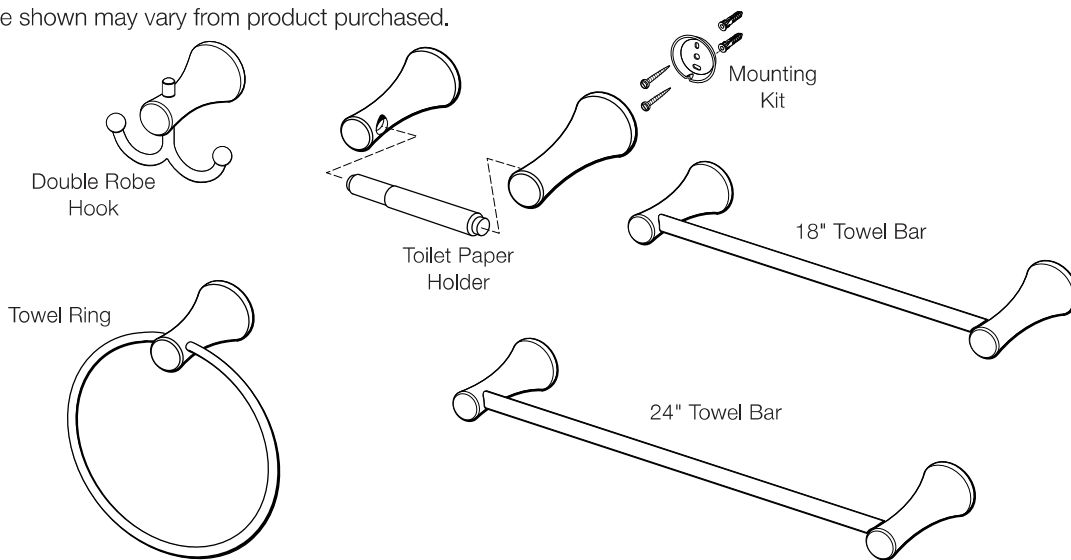

### RECOMMENDED TOOLS

Installation steps will indicate which tools should be used with associated letter

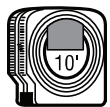

Tape measure

**A**



Level

**B**

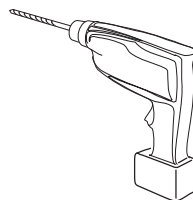

Drill

**C**

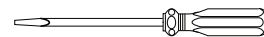

Screwdrivers

**D**

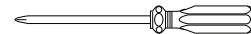

Hex wrench

**E**



### BEFORE INSTALLING YOUR FAUCET

Turn off hot and cold water supplies before beginning.

*American Standard*

# INSTALLATION INSTRUCTIONS

1

## INSTALLATION OF MOUNTING BRACKETS FOR ALL WALL MOUNTED ACCESSORIES

- The WALL MOUNTED ACCESSORIES work best if secured to a wall stud or cross brace within the wall, using the SCREWS (2) supplied.
- If the ACCESSORY is to be installed on a tile or plaster wall, the ANCHORS (3) and SCREWS (2) should be used.
- Determine desired height and location (optional) and mark a center line. Make sure the centerline is level. Using the MOUNTING BRACKET (1) as a template, mark the two spots for the mounting holes. If MOUNTING BRACKET (1) is secured to a stud or cross brace, drill small pilot holes for SCREWS (2).
- For installations on tiled walls or drywall, use TILE ANCHORS (3) and SCREWS (2) for securing MOUNTING BRACKET (1) to wall. Drill two 1/4" diameter holes a minimum of 1-1/4" deep. Insert the two TILE ANCHORS (3) flush with face of finished wall. Place MOUNTING BRACKET (1) over TILE ANCHORS (3) and insert SCREWS (2) provided with a flat blade screwdriver. See illustration below.
- Secure MOUNTING BRACKET (1) to wall with SCREWS (2).

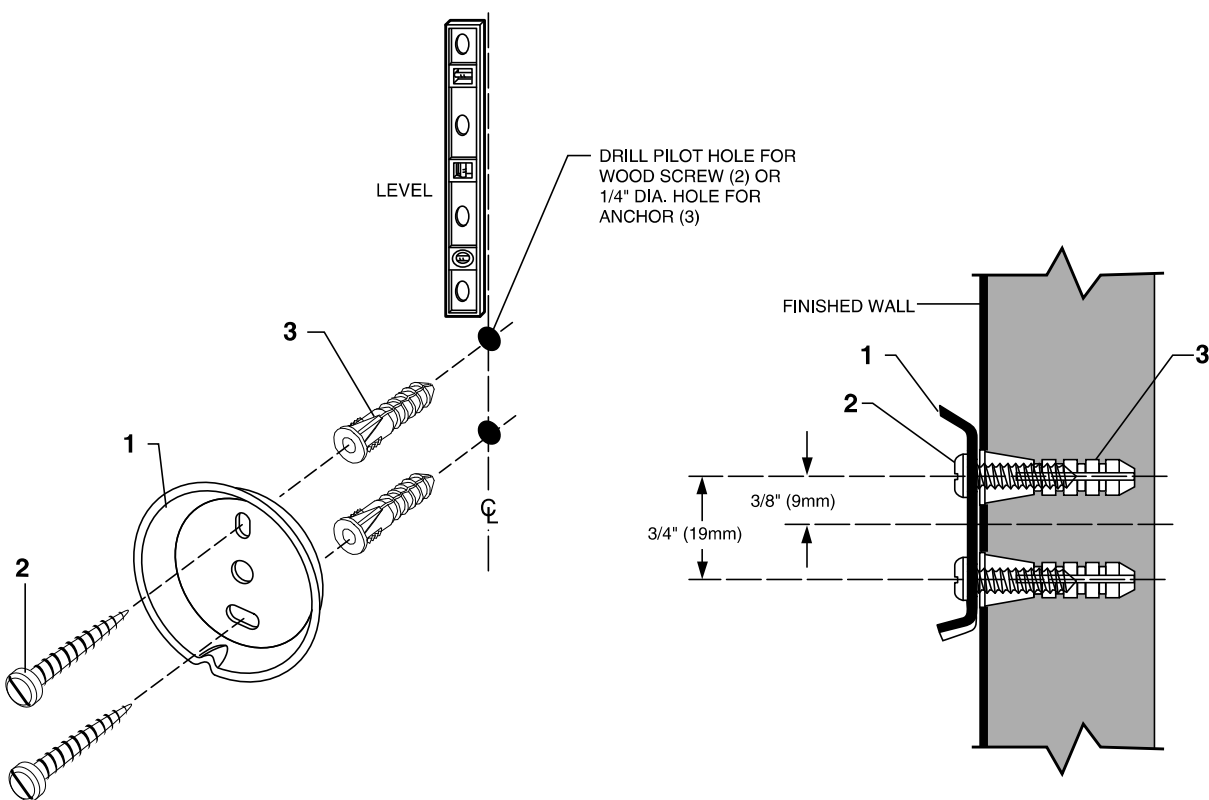

## 2

### TOWEL RING AND ROBE HOOK INSTALLATION

- Refer to **Step 1** for installation of MOUNTING BRACKETS (2). Align accessory and place ACCESSORY ESCUTCHEON (1) onto MOUNTING BRACKET (2). Secure accessory with SET SCREW (3) using a 4mm HEX WRENCH (4).

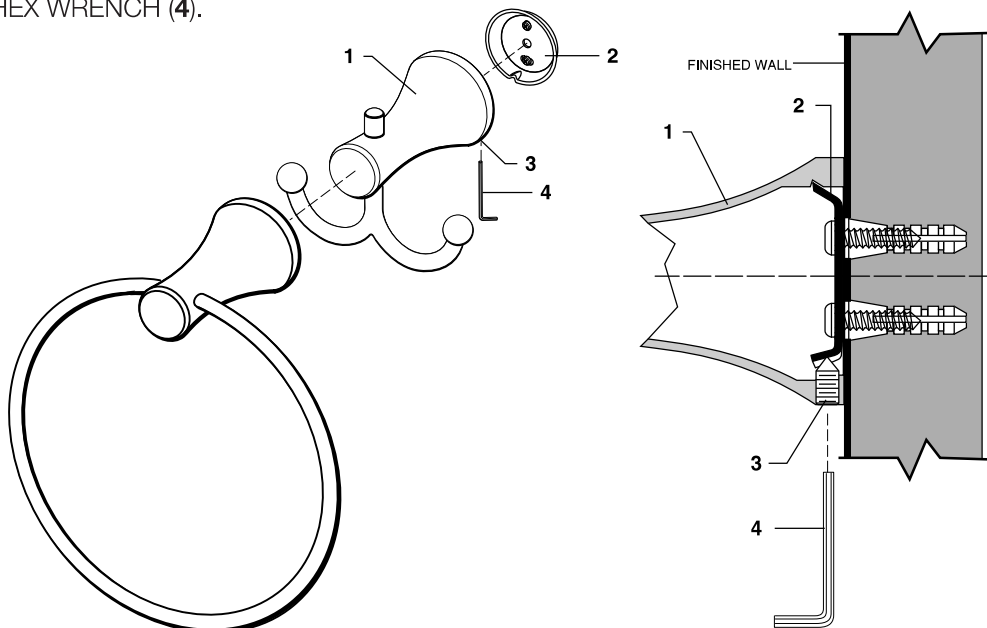

## 3

### INSTALL TOILET PAPER HOLDER

- Refer to **Step 1** for installation of MOUNTING BRACKETS (1). **NOTE: The center line distance between the two MOUNTING BRACKETS is 6-1/2" (166mm). Make sure the two MOUNTING BRACKETS (1) are level.**
- Install the ACCESSORY ESCUTCHEONS (2) on the MOUNTING BRACKETS (1). Make sure the ACCESSORY ESCUTCHEONS (2) with holes for the horizontal shaft are facing inward. Secure ACCESSORY ESCUTCHEONS (2) with SET SCREW (3) using a 4mm HEX WRENCH (4).
- Install the PAPER HOLDER SHAFT (5) into the mounted ACCESSORY ESCUTCHEONS (2).

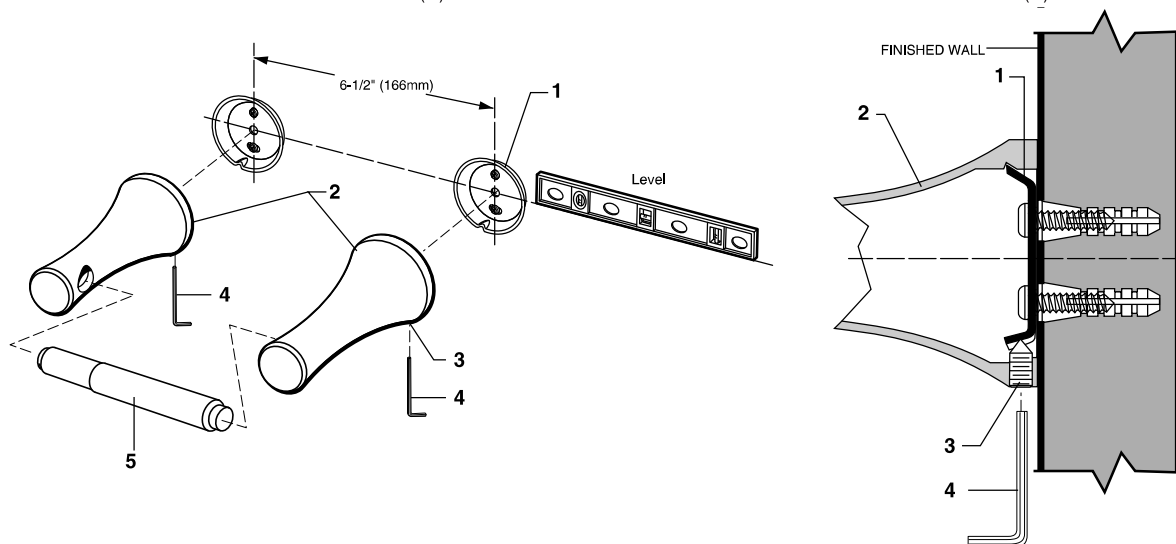

## 4

## 18" AND 24" TOWEL BAR INSTALLATION

- Refer to **Step 1** for installation of MOUNTING BRACKETS (1). **NOTE: The center line distance between the two MOUNTING BRACKETS is 18" (457.2mm) or 24" (609.6mm). Make sure the two MOUNTING BRACKETS (1) are level.**
- Install the ACCESSORY ESCUTCHEONS (2) on the MOUNTING BRACKETS (1). Secure ACCESSORY ESCUTCHEONS (2) with SET SCREW (3) using a 4mm HEX WRENCH (4).

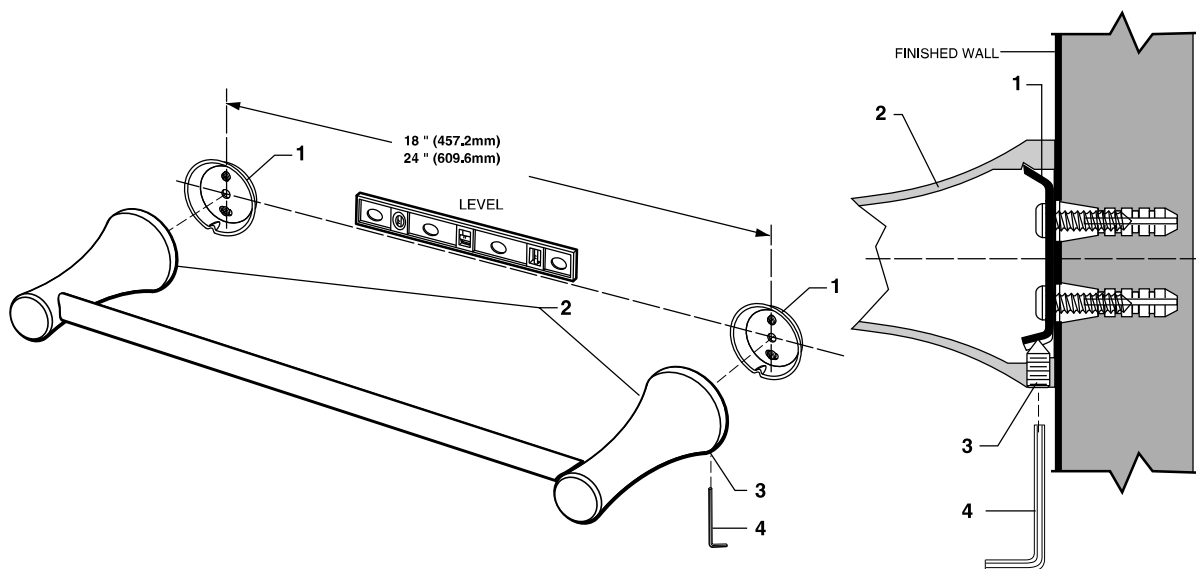

## 5

## CARE INSTRUCTIONS:

**DO:** SIMPLY RINSE THE PRODUCT CLEAN WITH CLEAR WATER. DRY WITH A SOFT COTTON FLANNEL CLOTH. **DO NOT:** DO NOT CLEAN THE PRODUCT WITH SOAPS, ACID, POLISH, ABRASIVES, HARSH CLEANERS, OR A CLOTH WITH A COARSE SURFACE.

*American Standard*

# TELL US WHAT YOU THINK!

Please leave us a product review or story  
at **AmericanStandard.com/reviews**

Find installation videos at  
**youtube.com/americanstandard**

Register your warranty and sign up for an idea-filled newsletter at  
**AmericanStandard-us.com/support/warranty**

**PLEASE COMPLETE AMERICAN STANDARD WARRANTY REGISTRATION PROCESS AND  
SAVE THIS WARRANTY INFORMATION IMPORTANT:**

Registration of the sink must be completed for this warranty to become effective. Your registration will make it easier to contact you in the event of a product recall.\*

**INSTRUCTIONS:** Register your sink at [www.americanstandard.com](http://www.americanstandard.com). Please save your proof of purchase (sale receipt). If you need assistance or do not have access to our website, please contact American Standard Customer Care at: (800) 442-1902. An American Standard representative will assist in completing the warranty registration.

\*In California, your warranty rights remain intact even if you do not complete the registration process.



## SHARE YOUR NEW PRODUCT!

Tag us @american\_standard on Instagram  
and show us how your new product looks.

## WANT MORE INFO?

For questions or help call us at **855-815-0004**,  
or visit **AmericanStandard.com**

### UNITED STATES

American Standard Brands  
865 Centennial Ave.  
Piscataway, New Jersey 08854  
Attention: Director of Customer Care  
For residents of the United States,  
warranty information may also be  
obtained by calling the following  
toll free number: (855) 815-0004  
[www.AmericanStandard.com](http://www.AmericanStandard.com)

### CANADA

LIXIL Canada, Inc.  
5900 Avebury Rd.  
Mississauga, Ontario  
Canada L5R 3M3  
Toll Free: (800) 387-0369  
[AmericanStandard.ca/support/warranty](http://AmericanStandard.ca/support/warranty)

### MEXICO

American Standard B&K Mexico  
S. de R.L. de C.V.  
Via Morelos #330  
Col. Santa Clara  
Ecatepec 55540 Edo. Mexico  
Toll Free: 800-839-1200  
[AmericanStandard.com.mx/garantia](http://AmericanStandard.com.mx/garantia)

M965366 EN (7/23)  
8337018/8337024/8337190/8337210/8337230

PART OF **LIXIL**

*American Standard*