

INSTALLATION INSTRUCTIONS

Flash™ Shower Valve Rough With Screwdriver Stops

Thank you for selecting American-Standard...
the benchmark of fine quality for over 140 years.

To ensure that your installation proceeds smoothly-please
read these instructions carefully before you begin.

RU101SS
RU102SS
RU107SS
RU108SS
RU109SS
RU107ESS
RU108ESS

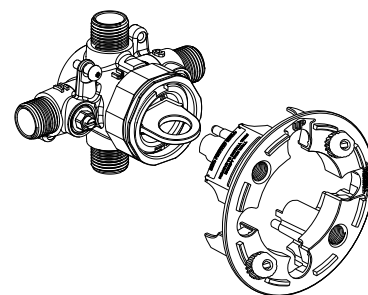

RECOMMENDED TOOLS

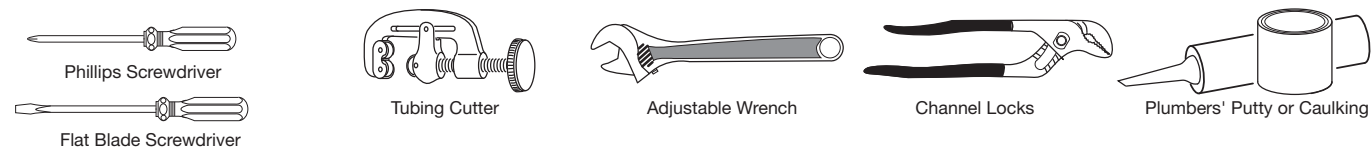

ROUGHING-IN DIMENSIONS

■ To assure proper positioning in relation to wall,
note roughing-in dimensions.

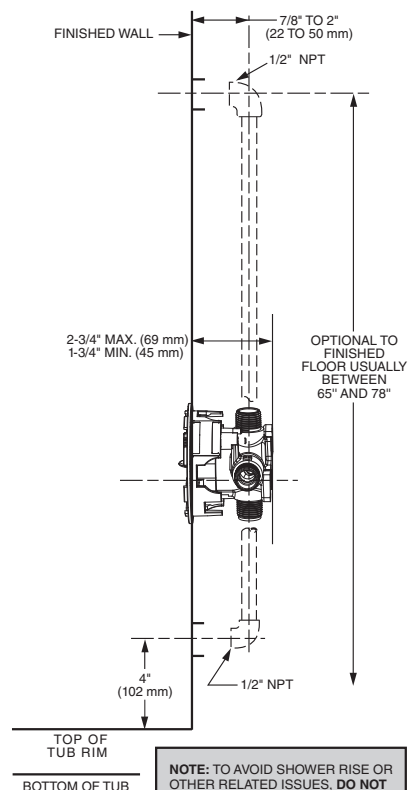
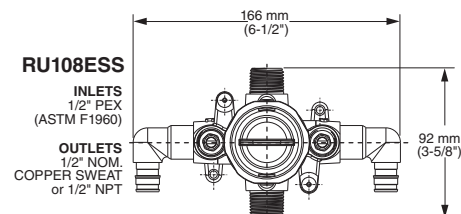
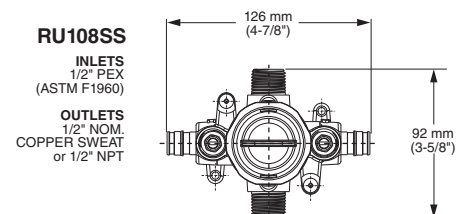
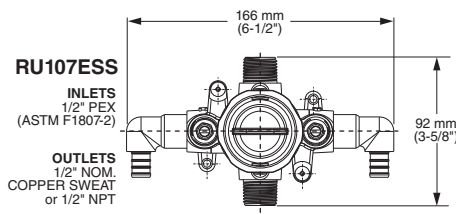
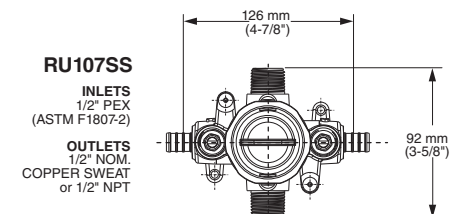
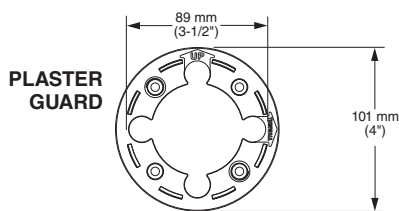
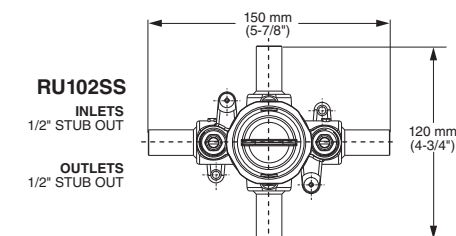
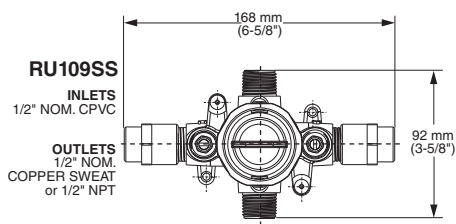
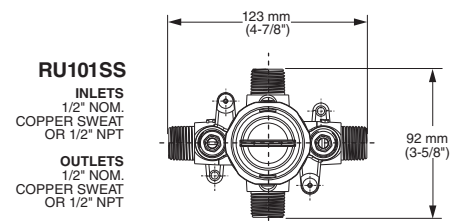

NOTE: TO AVOID SHOWER RISE OR
OTHER RELATED ISSUES, **DO NOT**
USE PEX CONNECTIONS AT THE TUB
OUTLET CONNECTING TO THE TUB
SPOUT.

1 STANDARD WALL INSTALLATION

CAUTION

Turn off hot and cold water supplies before beginning.

- See Roughing-in diagram before starting.
- Remove the PLASTER GUARD (8) for proper installation.
- Mount VALVE BODY to cross brace (2" X 4") with-in wall. Use wood screws to secure VALVE BODY to brace.
- Connect HOT and COLD water supplies per connection method of selected valve.

CAUTION: Service stops and flush plug must be removed before soldering.

- Connect RISER PIPE (1) to VALVE BODY (2) top outlet marked "UP".
- Connect TUB FILLER PIPE (3) to bottom outlet.
- Install PLASTER GUARD (8) back onto the valve. Only remove PLASTER GUARD (8) when ready to install trim Kit.
- Finished wall should allow for a 4" diameter opening (Use PLASTER GUARD for guidance)
- Screw driver stops are primarily used to shut water off. To shut "HOT" or "COLD" water using a flat head screw driver, turn the head of the screw vertically. And to turn the water back on, turn the screw horizontally.

CAUTION: After valve installation, inspect the VALVE BODY for any debris. It can damage Pressure Balance Valve cartridge.

NOTE: For back to back installation, follow steps mentioned above. Reversal of Hot/Cold water supplies is accomplished by rotating cartridge (supplied with trim) 180° during installation.

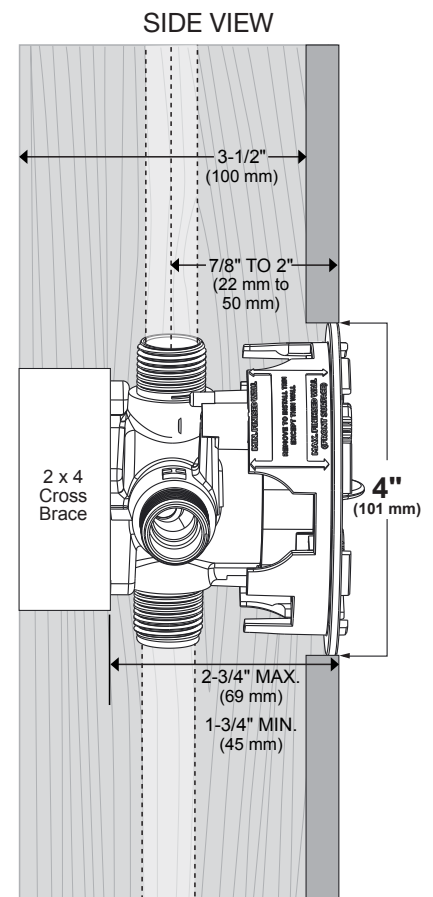
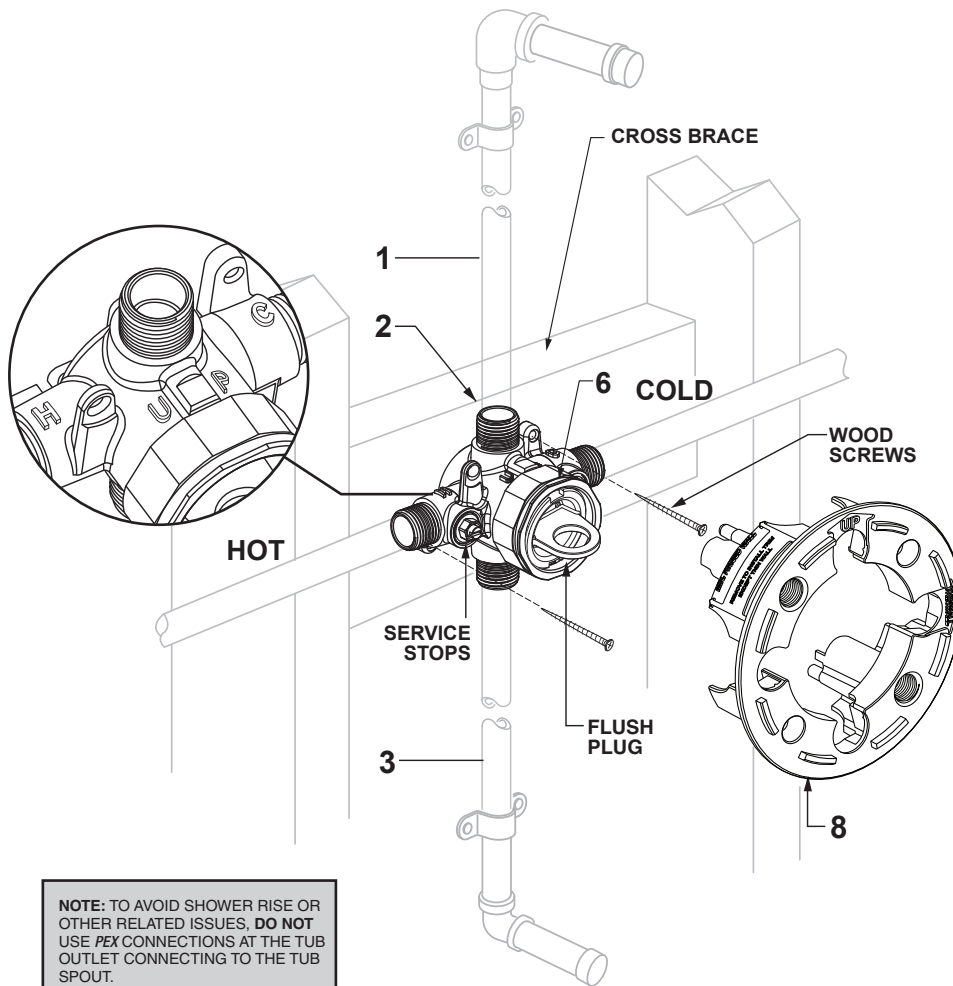

NOTE: TO AVOID SHOWER RISE OR OTHER RELATED ISSUES, DO NOT USE PEX CONNECTIONS AT THE TUB OUTLET CONNECTING TO THE TUB SPOUT.

2 THIN WALL INSTALL

CAUTION

Turn off hot and cold water supplies before beginning.

- See Roughing-in diagram before starting.
- Finished wall should allow for a 3-1/2" diameter opening (Use PLASTER GUARD for guidance).
- Remove PLASTER GUARD (8), rotate 90° counter clockwise and install the two screws. (Thin wall text should be on top)
- Use SELF-CENTERING HOLE GUIDES (9) as a guide for thin wall install.
- LOCKING SCREW (10) keeps valve in place when installing. Completely Thread LOCKING SCREW (10) onto PLASTER GUARD (8).
- During the installation, make sure to position the Locking feature screw as shown in **Figure A** below. Once the valve is positioned on the Thin Wall, turn counterclockwise as shown in **Figure B** to secure VALVE BODY (2) in place.

CAUTION: Service stops and flush plug must be removed before soldering.

- Connect HOT and COLD water supplies per connection method of selected valve.
- Connect RISER PIPE (1) to VALVE BODY (2) top outlet marked "UP".
- Connect TUB FILLER PIPE (3) to bottom outlet.

CAUTION: After valve installation, inspect the VALVE BODY for any debris. It can damage Pressure Balance Valve cartridge.

NOTE: For back to back installation, follow steps mentioned above. Reversal of Hot/Cold water supplies is accomplished by rotating cartridge (supplied with trim) 180° during installation.

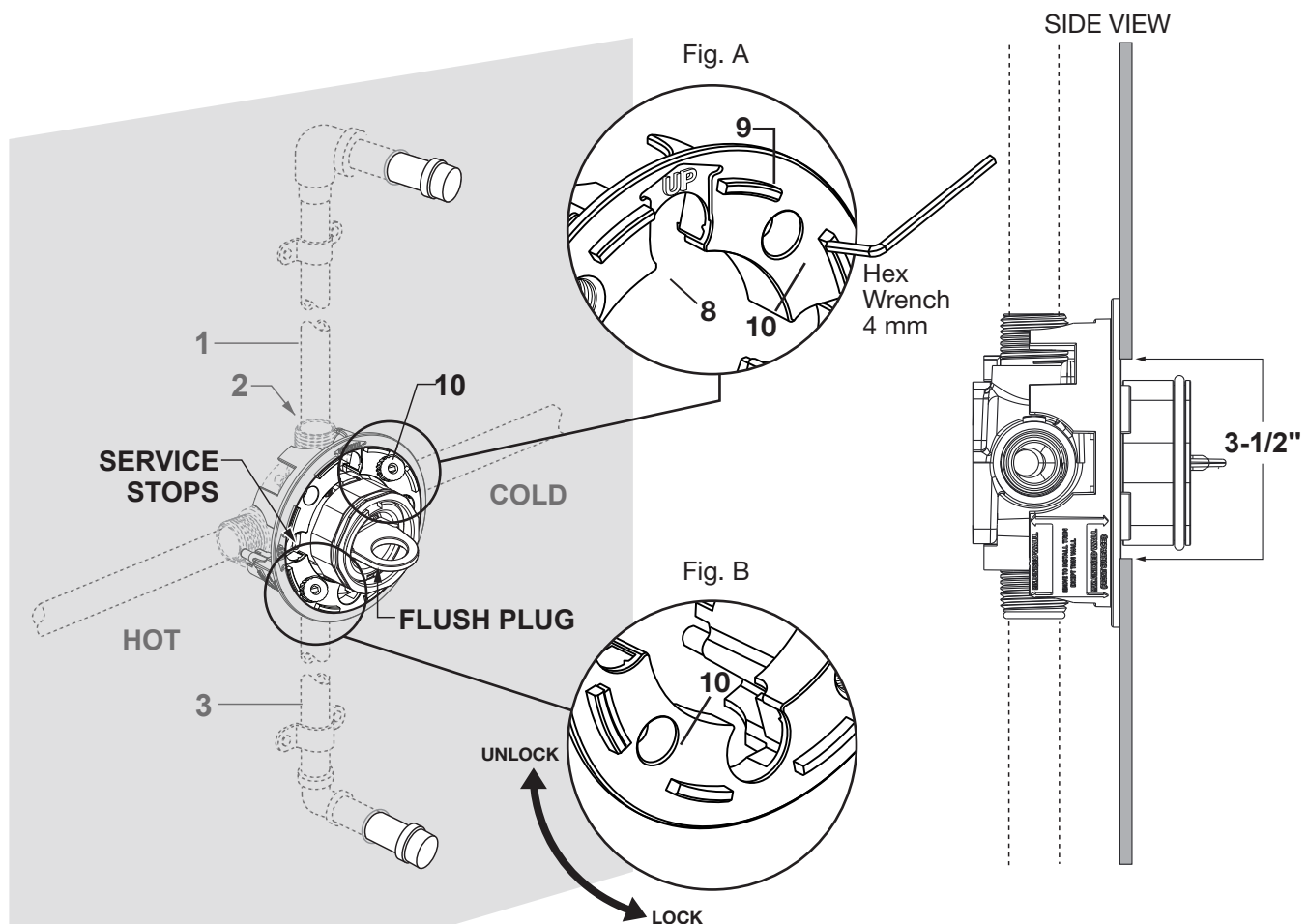

3

Turn off hot and cold water supplies before beginning.

- Install Mounting Screws (7) through Escutcheon Holder (8) and into Threaded holes (6). Tighten Mounting Screws (7) Securely.

Note: MOUNTING PLATE (4), Mounting Screws (7), Escutcheon Holder (8), and the two SCREWS (5) can be found packaged with the Belshire Trim rather than the valve.

CAUTION: Service stops and flush plug must be removed before soldering.

- Connect HOT and COLD water supplies per connection method of selected valve.
- Connect RISER PIPE **(1)** to VALVE BODY **(2)** top outlet marked “UP”.
- Connect TUB FILLER PIPE **(3)** to bottom outlet.
- Service stops are primarily used to shut water off. To shut “HOT” or “COLD” water using a flat head screwdriver, turn the head of the screw vertically. And to turn the water back on, turn the screw horizontally.

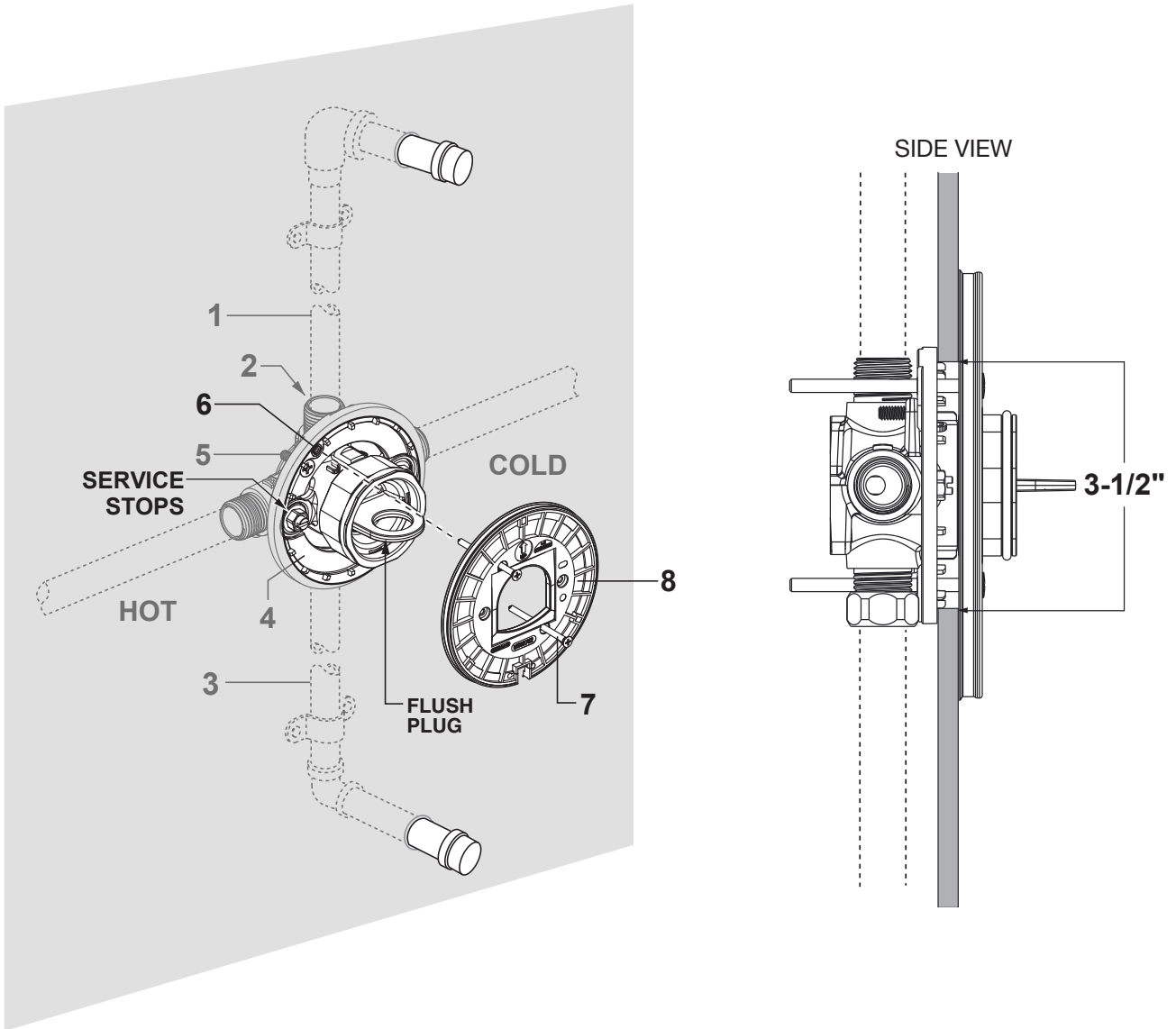

4 TEST PROCEDURES FOR FLUSH PLUG

- Valve comes with Flush Plug that allows hot and cold supply lines to be flushed independently (without cross flow).
- Flush plug is shipped in **Orientation A**.
 - **ORIENTATION A** directs cold water through the shower port and hot water through the tub port.
- Flush plug can be reversed to **Orientation B**.
 - **ORIENTATION B** directs cold water through the tub port and hot water through the shower port.
- For shower only installation flush cold supply line first in **Orientation A**. Then reverse to **Orientation B** and flush hot supply line. Alternatively, the flush plug can be removed entirely to flush water through the valve body.
- To switch between orientations follow these steps:
 - Unthread BONNET NUT (1).
 - Rotate FLUSH PLUG (2) 90 degrees to desired orientation.
 - Rethread BONNET NUT (1).
- Upon completion of flushing both hot and cold supply lines unthread BONNET NUT (1), remove FLUSH PLUG (2), and rethread BONNET NUT (1).

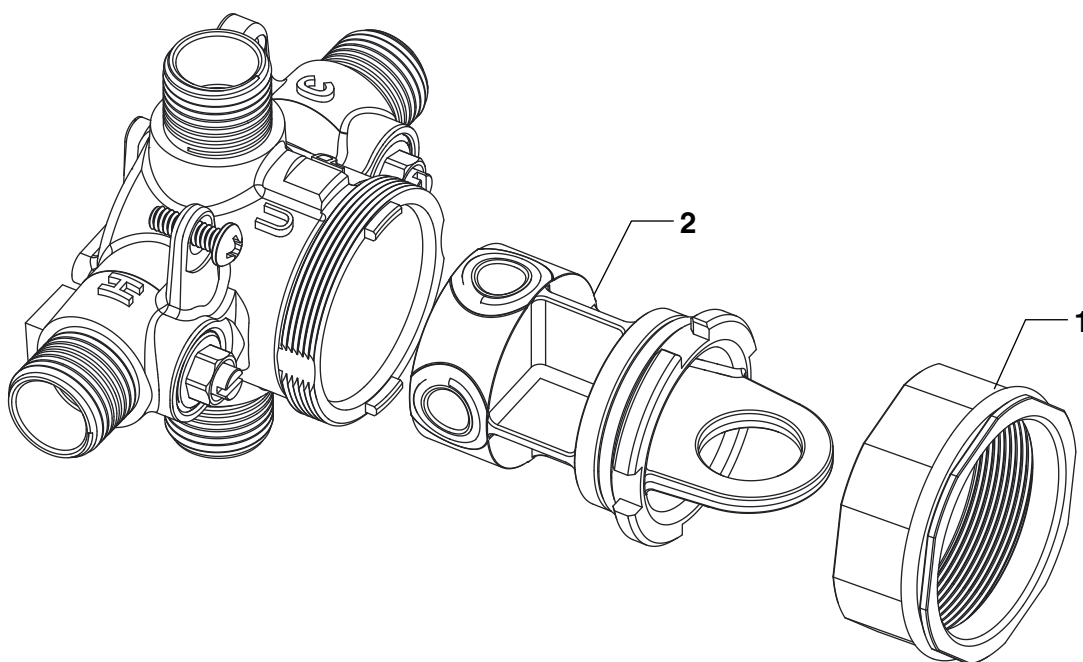

ORIENTATION A (as shipped)

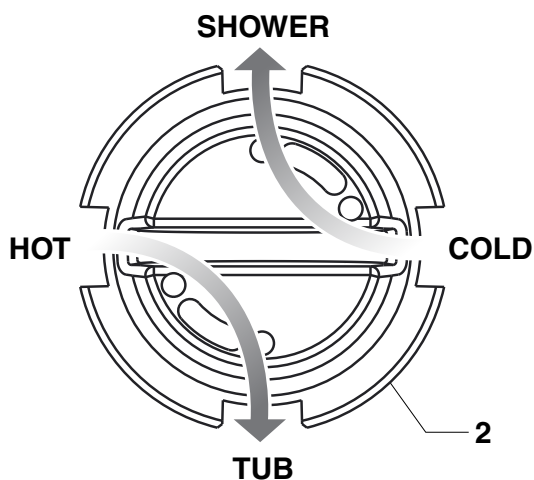

ORIENTATION B

