

# ELKAY® Quartz Perfect Drain™ Installation Instructions

For all non-disposer installations in Quartz Perfect Drain™.

## STEP 1

Install and properly seat **Drain Seal** within groove of **Flange**.  
Incorrect installation may allow leaks and void the warranty!

Apply non-staining plumbers putty to underside of **Flange**.

Apply non-staining plumbers putty to underside of **Flange**.

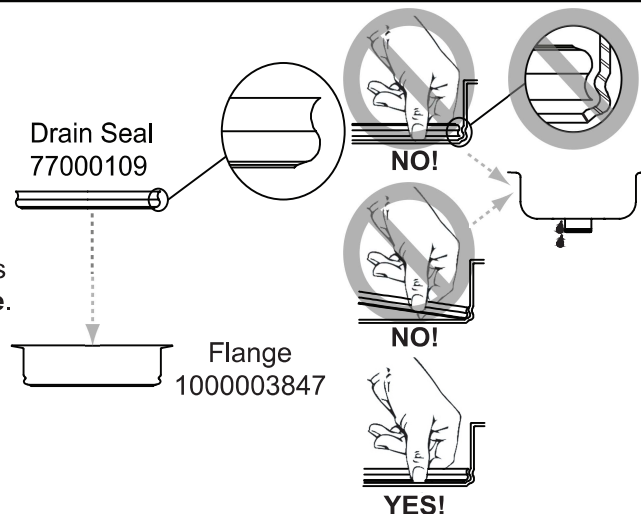

## STEP 2

Properly seat **Drain Body** into **Flange**.

Insert **Flange** into sink.

Place **Gasket** over **Flange**. Install **Housing** over **Flange**.

Thread **Lock Nut** onto **Drain Body**.  
Place **Poly Washer** on **Tailpiece**.

Install **Tailpiece Assembly** onto **Drain Body** with **Coupling Nut**.

Check for leaks and place **Strainer Basket** into **Drain Body**.

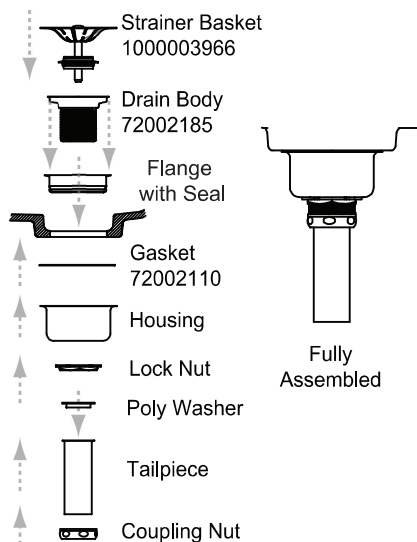

**BE CAREFUL TO NOT OVER TIGHTEN THE FITTINGS.**

In keeping with our policy of continuing product improvement, Elkay reserves the right to change product specifications without notice. Please visit [elkay.com](http://elkay.com) for most current version of Elkay product specification sheets.

This specification describes an Elkay product with design, quality, and functional benefits to the user. When making a comparison of others producers offerings, be certain these features are not overlooked.

**Zurn Elkay**

1333 Butterfield Road, Suite 200  
Downers Grove, IL 60515

©2024 Zurn Elkay  
[elkay.com](http://elkay.com)

PART NO. 1000003889  
Rev: 03/24