



Count on it.

T7 Series Rotor User's Guide

◆ To position the left stop:

- ◆ The fixed left stop is indicated by the arrow on the sprinkler cap. Align the fixed stop to the left border by turning the sprinkler body. The right stop is adjustable from 40°-360°.

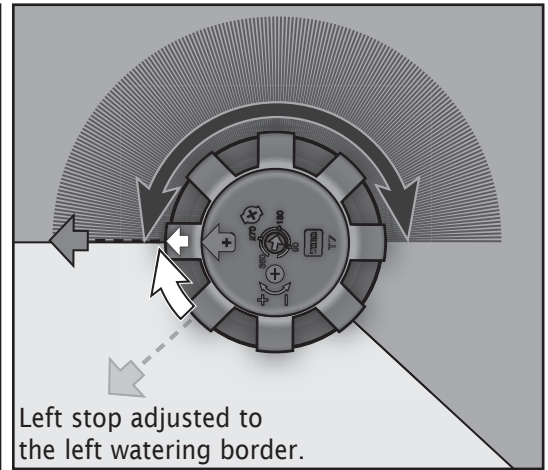
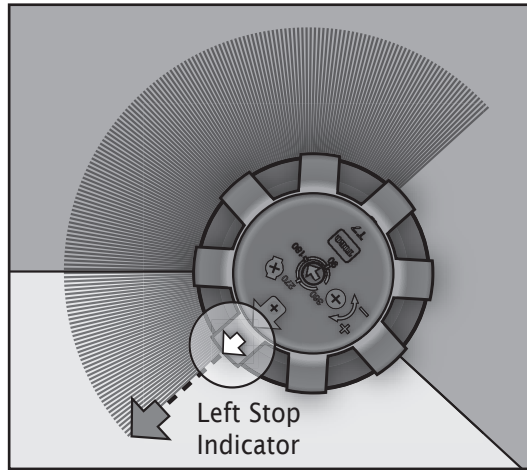
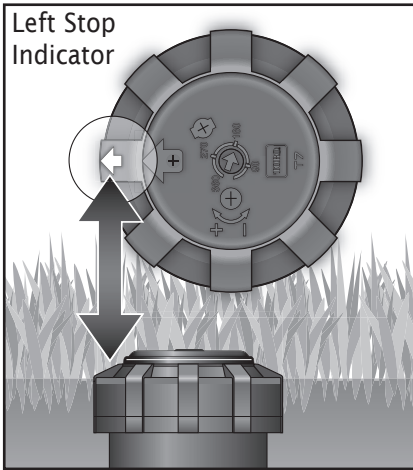

◆ To adjust the spray arc:

- ◆ To adjust the right stop, insert tool blade into cap. Turn blade left to decrease arc; right to increase arc.

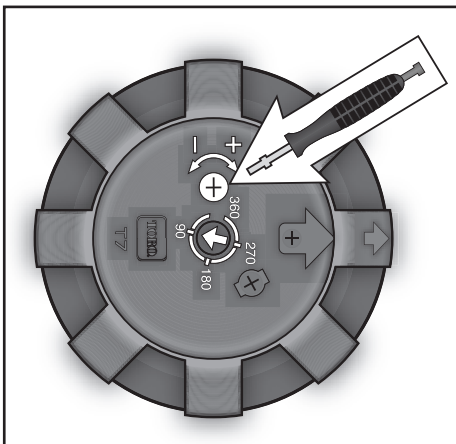

Spray arc can be decreased down to 40°.

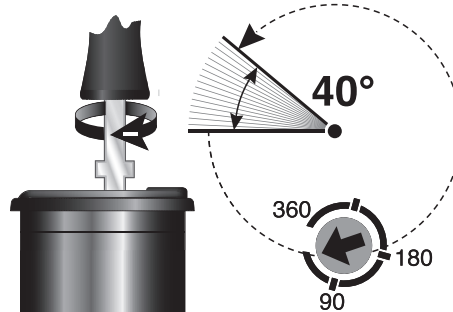

Spray arc can be increased up to 360°.

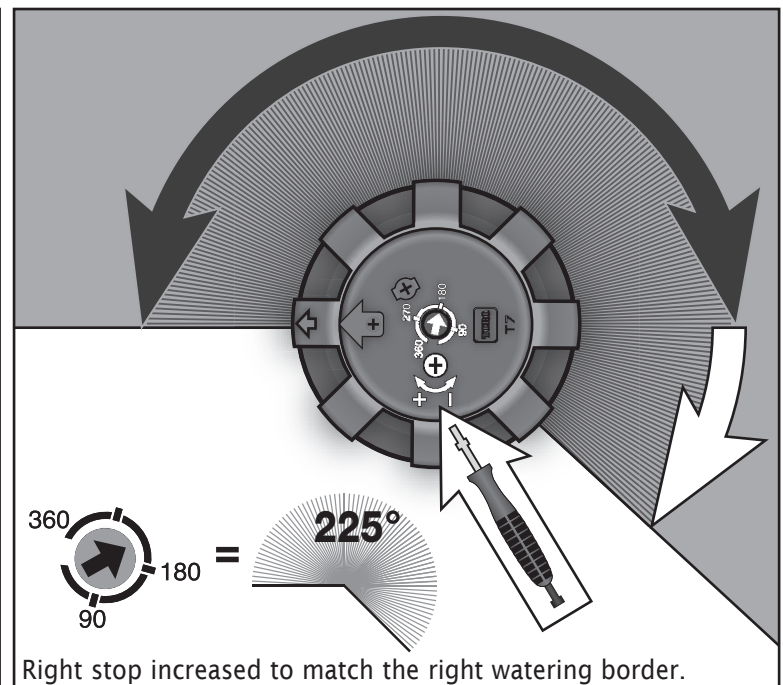
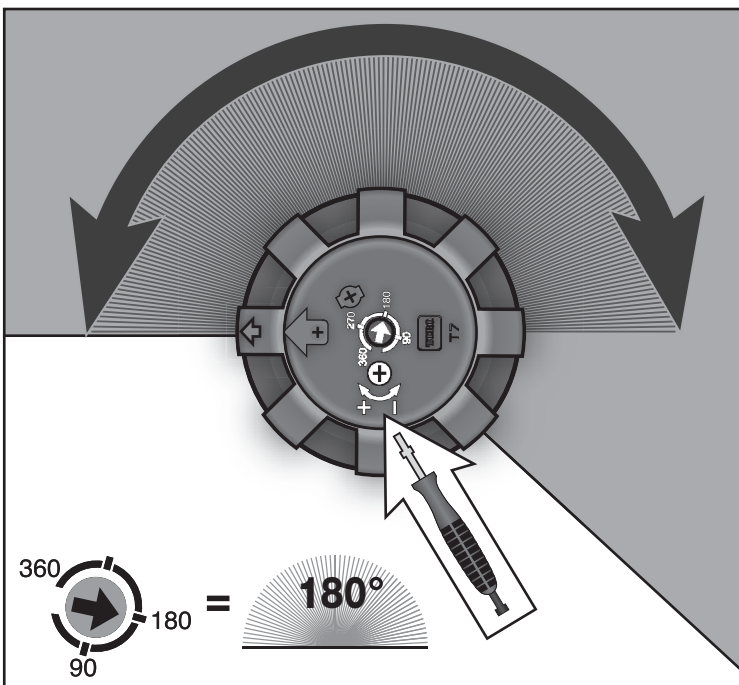
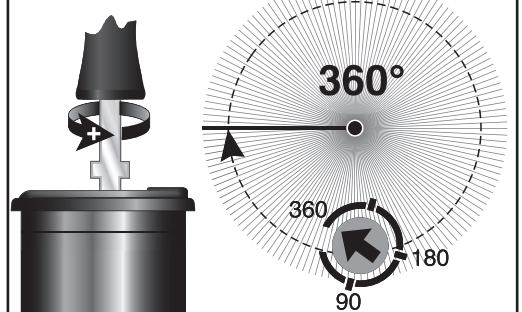

◆ To pull the nozzle riser up:

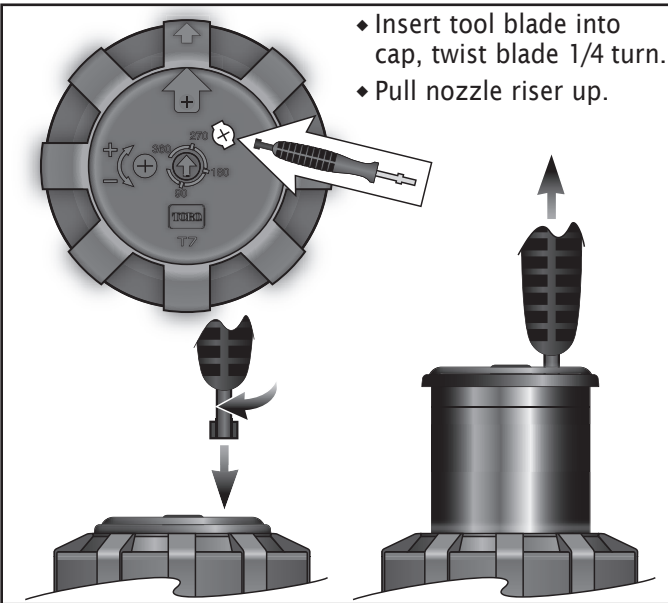

◆ To change the nozzle/diffuse spray:

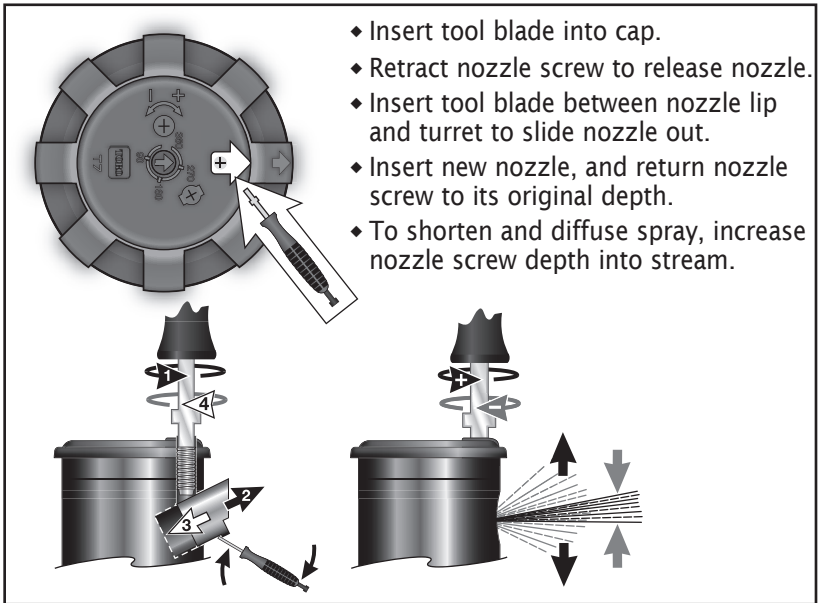

◆ To install the check valve:

The T7 is equipped with a two-way check valve. To eliminate check valve function, install the check valve disk in position B.

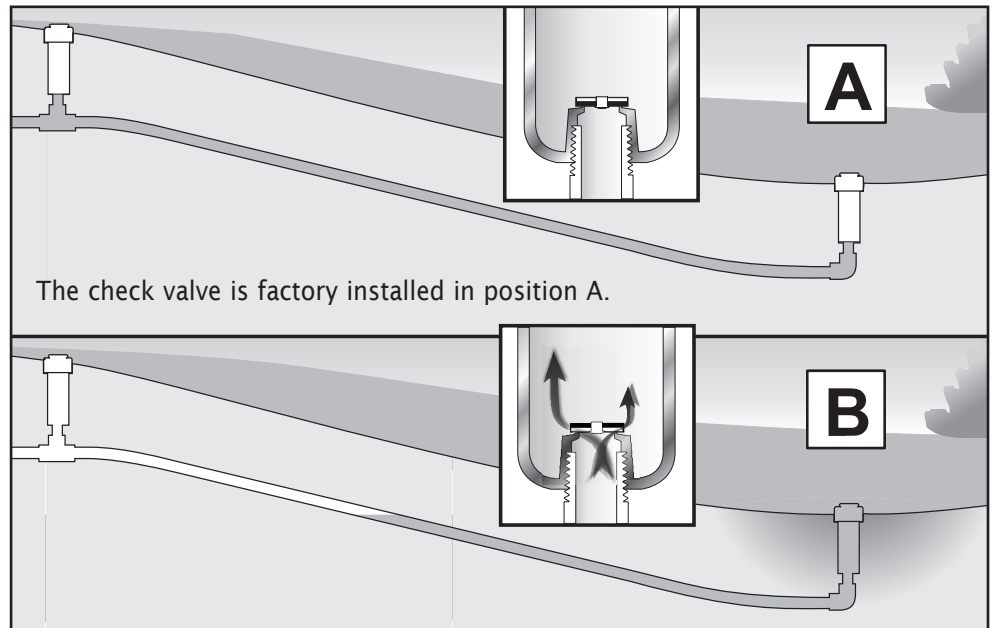
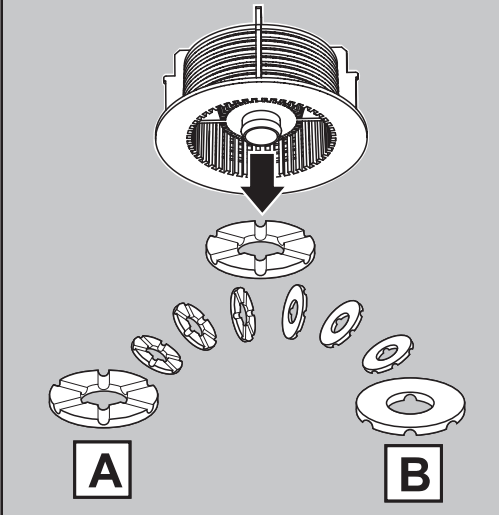

◆ T7 Nozzle Performance

Nozzle	Pressure PSI	Radius ft.	Flow GPM	Precip. in/h ▲	Precip. in/h ■	Pressure Bar	Flow +/-10% L/M
7	50	48	7.4	0.32	0.36	3,4	28,01
	60	49	8.1	0.33	0.38	4,1	30,66
	70	51	8.8	0.33	0.38	4,8	33,31
	80	52	9.6	0.34	0.39	5,5	36,34
	90	53	10.2	0.35	0.40	6,2	38,61
	100	54	10.7	0.35	0.41	6,9	40,50
9	50	51	8.4	0.31	0.36	3,4	31,80
	60	52	8.6	0.31	0.35	4,1	32,55
	70	53	9.6	0.34	0.39	4,8	36,34
	80	54	10.3	0.34	0.39	5,5	38,99
	90	55	10.9	0.35	0.40	6,2	41,26
	100	56	11.5	0.35	0.41	6,9	43,53
12	50	56	10.5	0.32	0.37	3,4	39,75
	60	58	11.4	0.33	0.38	4,1	43,15
	70	60	12.4	0.33	0.38	4,8	46,94
	80	61	13.4	0.35	0.40	5,5	50,72
	90	62	14.2	0.36	0.41	6,2	53,75
	100	63	15.1	0.37	0.42	6,9	57,16
16	50	59	14.7	0.41	0.47	3,4	55,65
	60	61	15.7	0.41	0.47	4,1	59,43
	70	63	17.0	0.41	0.48	4,8	64,35
	80	65	18.2	0.41	0.48	5,5	68,89
	90	66	19.4	0.43	0.50	6,2	73,44
	100	68	20.5	0.43	0.49	6,9	77,60

Nozzle	Pressure PSI	Radius ft.	Flow GPM	Precip. in/h ▲	Precip. in/h ■	Pressure Bar	Flow +/-10% L/M
20	50	59	18.5	0.51	0.59	3,4	70,03
	60	61	19.7	0.51	0.59	4,1	74,57
	70	65	21.0	0.48	0.55	4,8	79,49
	80	68	22.5	0.47	0.54	5,5	85,17
	90	69	24.0	0.48	0.56	6,2	90,95
	100	71	25.3	0.48	0.56	6,9	95,77
24	50	59	17.9	0.50	0.58	3,4	67,76
	60	62	19.8	0.50	0.58	4,1	74,95
	70	65	21.6	0.49	0.57	4,8	81,76
	80	68	23.2	0.48	0.56	5,5	87,82
	90	69	25.0	0.50	0.58	6,2	94,64
	100	71	26.4	0.50	0.58	6,9	99,93
27	50	64	21.3	0.50	0.58	3,4	80,63
	60	70	23.7	0.46	0.54	4,1	89,71
	70	75	25.5	0.44	0.50	4,8	96,53
	80	77	27.1	0.44	0.51	5,5	102,58
	90	82	28.9	0.41	0.48	6,2	109,40
	100	83	30.5	0.43	0.49	6,9	115,46